



**Notice of Service Interruption/Area Closure**  
**Western University**  
**Facilities Management**  
**Client Services 519-661-3304 (fmhelp@uwo.ca)**

Submit by E-mail  
 Print Form

Date of Interruption/Closure:  Time(s):

Building(s) Affected: #1  #2   
 #3  #4   
 Areas/Rooms Affected Alternate Route/Service:

Service to be interrupted: #1  #2   
 #3  #4   
 Description/Reason for Project:

Requester:  Date of Request:

Supervising Tradesperson:  Unit:   
 Trade Manager:  Unit:  Date:

Contractor:  Phone #:   
 Coordinator/Project Manager:  Phone #:  Date:

Reviewed by Trade Manager(s)/Shop(s) Affected:

Name:	Date:	Name:	Date:
Signature/Stamp:		Signature/Stamp:	
Name:	Date:	Principal Occupants:	
Signature/Stamp:		Name:	Ext. Date:
Name:	Date:	Name:	Ext. Date:
Signature/Stamp:		Name:	Ext. Date:
Name:	Date:	Name:	Ext. Date:
Signature/Stamp:		Approval to Proceed: <input type="text"/> Date: <input type="text"/>	
Name:	Date:	<div style="border: 2px solid green; padding: 5px; text-align: center;"> <b>APPROVED</b>  <i>By Dan Trudgeon at 3:18 pm, Sep 13, 2016</i> </div>	
Signature/Stamp:			

Notes:

# CHB - LOWER GROUND N

OAT  
25.7 °C



**Reheat Valve**

- 25% OPEN (Yellow circle)
- 50% OPEN (Pink circle)
- 75% OPEN (Dark red circle)
- 100% OPEN (Blue circle)

**Perimeter Valve**

- 25% OPEN (Yellow triangle)
- 50% OPEN (Pink triangle)
- 75% OPEN (Dark red triangle)
- 100% OPEN (Blue triangle)

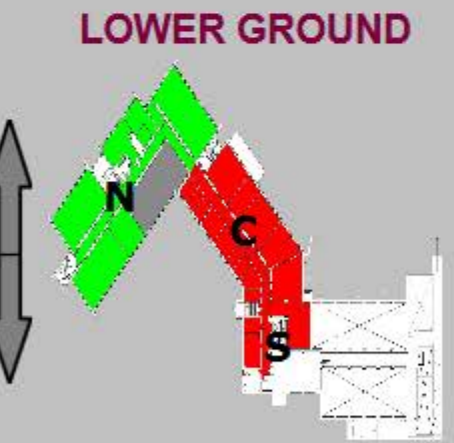

**Colour Block Legend :**

- CHB 101 (Red)
- CHB 103 (Green)
- CHB 106 (Grey)

Main Previous

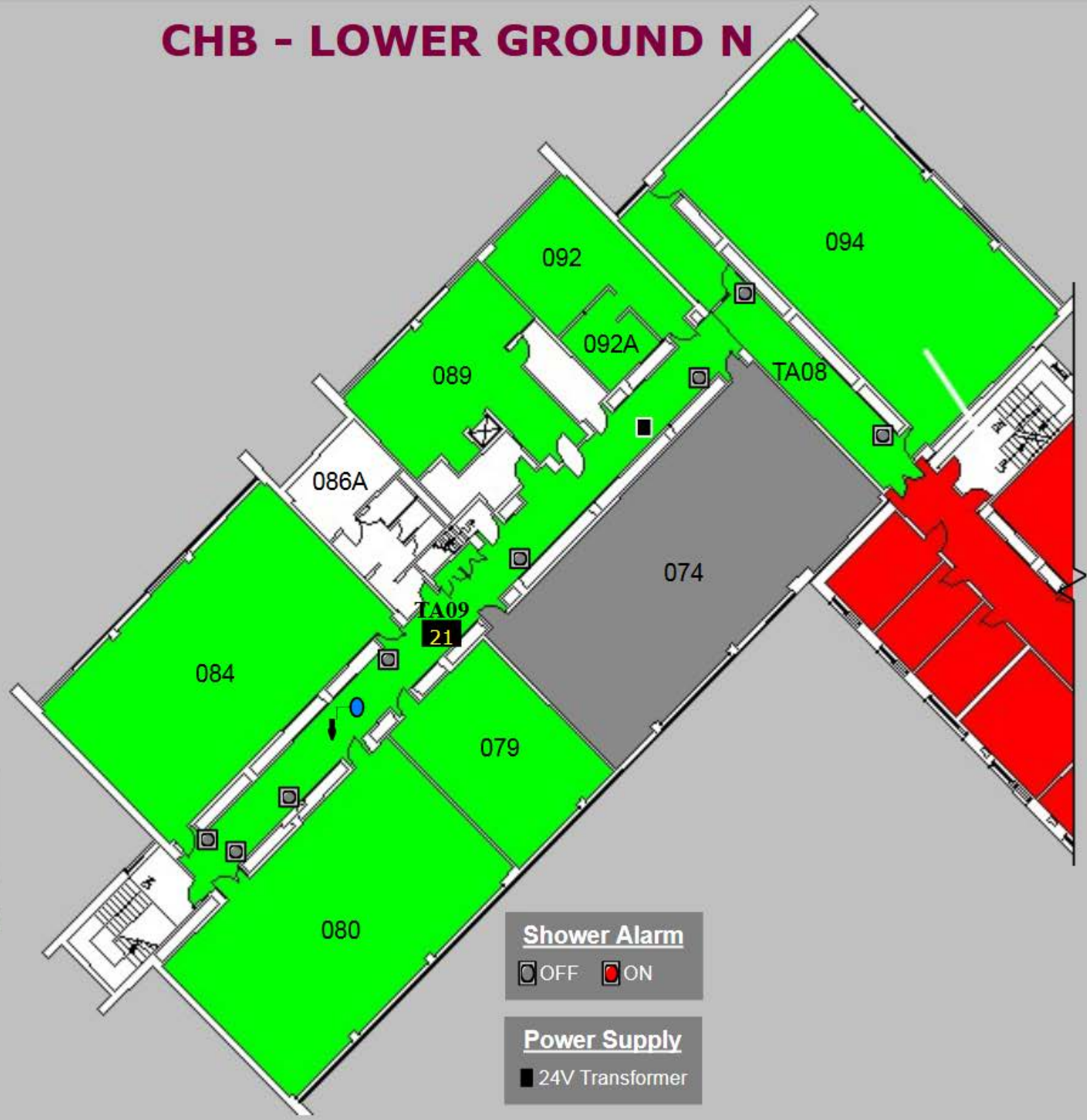

# CHB - BASEMENT N

OAT  
25.1 °C

- Reheat Valve**
- 25% OPEN
  - 50% OPEN
  - 75% OPEN
  - 100% OPEN

- Bypass Box**
- 25% BYPASS
  - 50% BYPASS
  - 75% BYPASS
  - 100% BYPASS

- Perimeter Valve**
- ▲ 25% OPEN
  - ▲ 50% OPEN
  - ▲ 75% OPEN
  - ▲ 100% OPEN

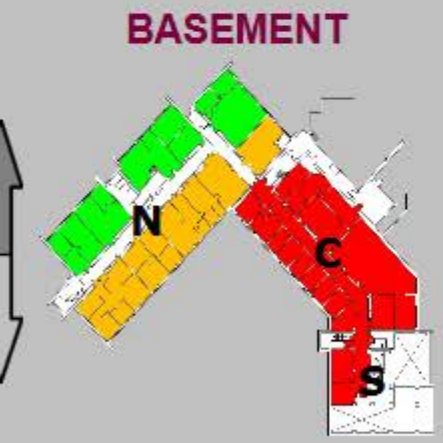

- Colour Block Legend :**
- CHB 101
  - CHB 103
  - CHB 104

Main Previous

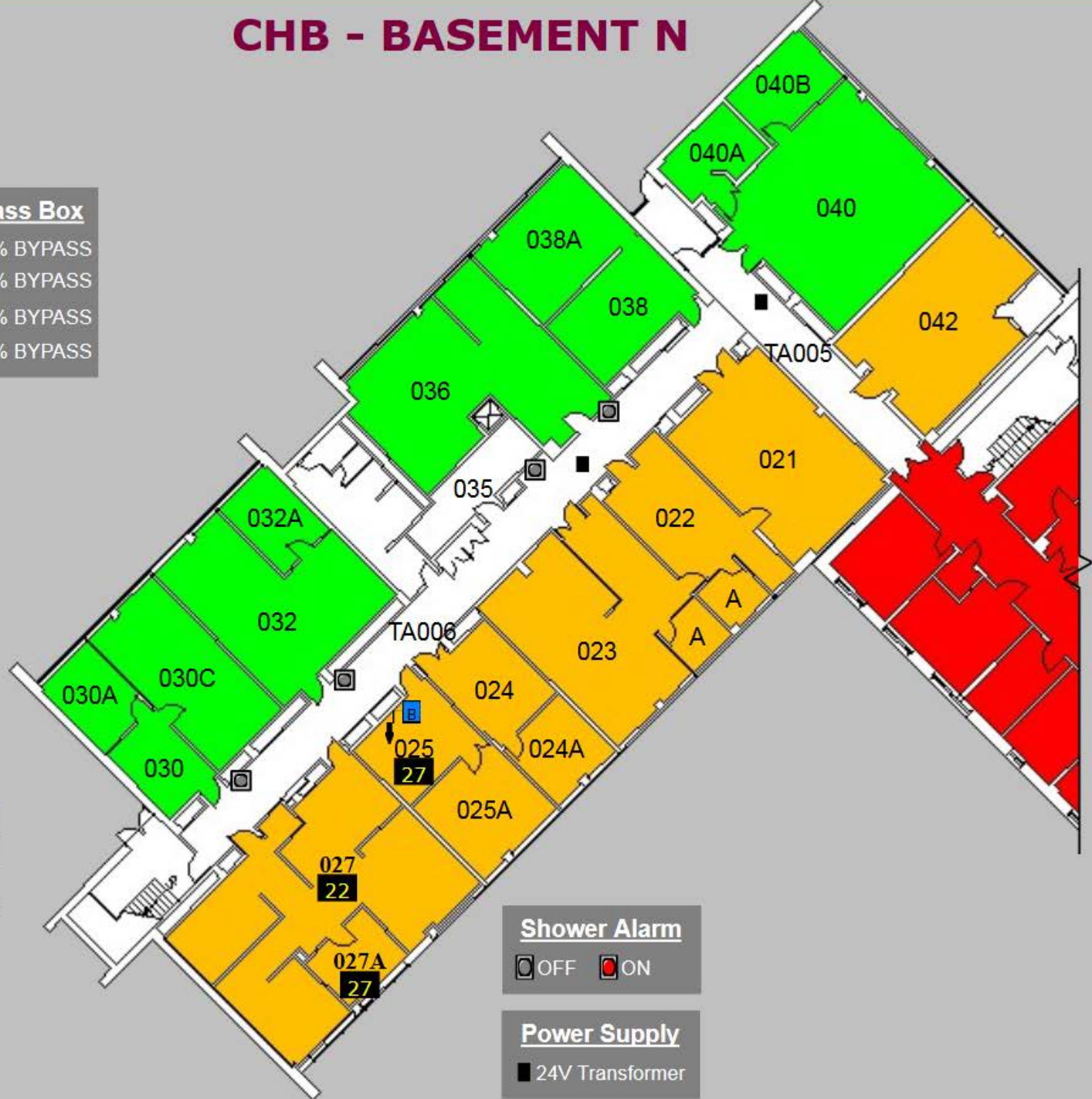

- Shower Alarm**
- OFF
  - ON

- Power Supply**
- 24V Transformer