



**Notice of Service Interruption/Area Closure**  
**Western University**  
**Facilities Management**  
**Client Services 519-661-3304 (fmhelp@uwo.ca)**

Submit by E-mail  
 Print Form

Date of Interruption/Closure:  Time(s):

Building(s) Affected: #1  #2   
 #3  #4

Areas/Rooms Affected Alternate Route/Service:

Service to be interrupted: #1  #2   
 #3  #4

Description/Reason for Project:

Requester:  Date of Request:

Supervising Tradesperson:  Unit:

Trade Manager:  Unit:  Date:

Contractor:  Phone #:

Coordinator/Project Manager:  Phone #:  Date:

Reviewed by Trade Manager(s)/Shop(s) Affected:

Name:	Date:	Name:	Date:
Signature/Stamp:		Signature/Stamp:	

Principal Occupants:

Name:	Ext.:	Date:
Name:	Ext.:	Date:
Name:	Ext.:	Date:
Name:	Ext.:	Date:

Approval to Proceed:  Date:

**APPROVED**  
 By Dara Gomez at 8:20 am, Jul 26, 2017

Notes:

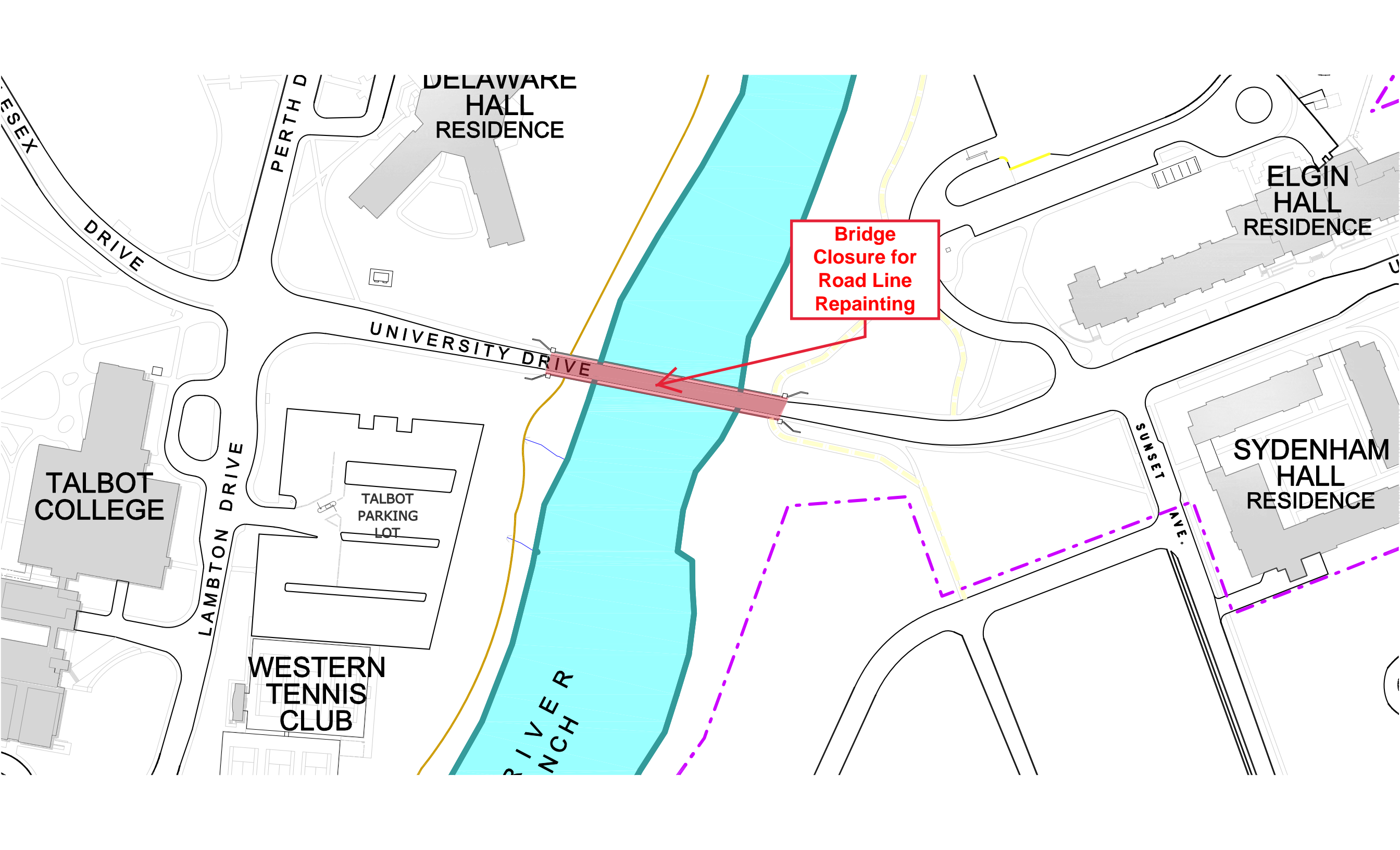

ESSEX DRIVE

PERTH D

DELAWARE HALL RESIDENCE

ELGIN HALL RESIDENCE

SYDENHAM HALL RESIDENCE

TALBOT COLLEGE

WESTERN TENNIS CLUB

TALBOT PARKING LOT

Bridge Closure for Road Line Repainting

UNIVERSITY DRIVE

LAMBTON DRIVE

SUNSET AVE.

RIVER BRANCH