



Notice of Service Interruption/Area Closure
Western University
Facilities Management
Client Services 519-661-3304 (fmhelp@uwo.ca)

Submit by E-mail
 Print Form

Date of Interruption/Closure: Time(s):

Building(s) Affected: #1 #2
 #3 #4

Areas/Rooms Affected Alternate Route/Service:
 All west side floors from 1st -9th except 8th floor animal facility.
 Elevator E, 6:00am-10:00am
 Supply & return air fan 101 & 102. All equipment in mech room 5001. See attached print for affected areas .

Service to be interrupted: #1 #2
 #3 #4

Description/Reason for Project:
 To replace 4 electrical panels throughout the building.

Requester: Date of Request:

Supervising Tradesperson: Unit:

Trade Supervisor: Unit: Date:

Contractor: Phone #:

Coordinator/Project Manager: Phone #: Date:

Reviewed by Trade Supervisor(s)/Shop(s) Affected:

Name: Electrical Mechanical Shop	Date:	Name: Electrical Shop	Date:
Signature/Stamp:		Signature/Stamp:	
Name: WES	Date:	Principal Occupants:	
Signature/Stamp: REVIEWED <small>By Wayne Drummond (ppdwad@uwo.ca) at 8:27 am, Nov 11, 2014</small>		Name:	Ext. Date:
Name: ACMF	Date:	Name:	Ext. Date:
Signature/Stamp:		Name:	Ext. Date:
Name: Plumber Fitter Shop	Date:	Approval to Proceed: <input type="text"/> Date: <input type="text"/>	
Signature/Stamp: REVIEWED <small>By Peter (pdearing@uwo.ca) at 8:21 am, Nov 11, 2014</small>		APPROVED <small>By Andrew (fmfinterr@uwo.ca) at 7:25 am, Nov 13, 2014</small>	

Notes:

AREA OF POWER SHUTDOWN ALL FLOORS FROM 7:00 AM - 2:00 PM EXCEPT FOR ANIMAL FACILITY ON 8TH FLOOR.

AREA OF FAN & HEATING SHUTDOWN ON ALL FLOORS & ELEVATOR E SHUTDOWN FROM 5:00 AM - 9:00 AM

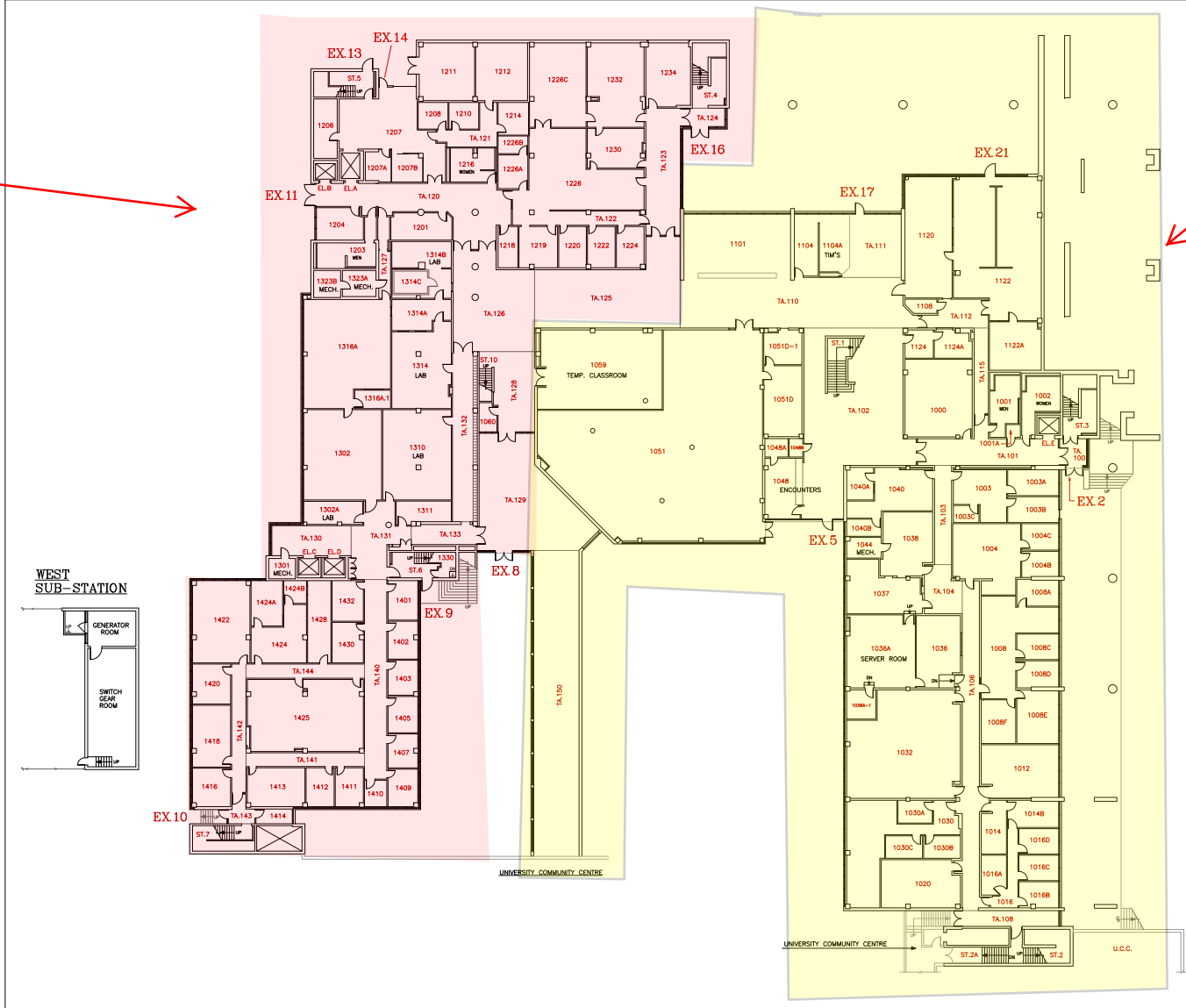

		SCALE DATE 2013-12-04 DRAWN R. THOMAS CHECKED APPROVED BUILDING NORTH
		DWG FILE No. SSC-01 GEOMETRIC ELEV.
FACILITIES MANAGEMENT		
BUILDING FLOOR PLAN - LEVEL 01 (FIRST FLOOR)		01