



Notice of Service Interruption/Area Closure
Western University
Facilities Management
Client Services 519-661-3304 (fmhelp@uwo.ca)

Submit by E-mail
 Print Form

Date of Interruption/Closure: Time(s):

Building(s) Affected: #1 #2
 #3 #4

Areas/Rooms Affected Alternate Route/Service:
 Areas served by Fans 103 & 104. See attached HVAC drawings. Fan 105 is on Emergency Power and will remain in service.
 Room 1310 - Fume Cabinet 014, Room 1314 - Fume Cabinet 004, Room 3435A - Fume Cabinet 023, Room 9316 - Fume Cabinet 008-009-010, Room 9322 - Fume Cabinet 011
 Washroom exhaust fans in tower part of building.

Service to be interrupted: #1 #2
 #3 #4

Description/Reason for Project:
 Taking out MCC serving HVAC fans and re-installing panel.

Requester: Date of Request:

Supervising Tradesperson: Unit:

Trade Supervisor: Unit: Date:

Contractor: Phone #

Coordinator/Project Manager: Phone # Date:

Reviewed by Trade Supervisor(s)/Shop(s) Affected:

Name: Electrical / Mechanical Shop	Date: Apr 13, 2016	Name: WES Control	Date: Apr 13, 2016
------------------------------------	--------------------	-------------------	--------------------

Signature/Stamp: **APPROVED**
 By *spepper* (spepper@uwo.ca) at 11:44 am, Apr 13, 2016

Signature/Stamp: **REVIEWED**
 By *Wayne Drummond* (ppdwad@uwo.ca) at 12:40 pm, Apr 13, 2016

Name: Date:

Principal Occupants:

Signature/Stamp:

Name:	Ext.	Date:
-------	------	-------

Name: Date:

Name:	Ext.	Date:
-------	------	-------

Signature/Stamp:

Name:	Ext.	Date:
-------	------	-------

Name: Date:

Name:	Ext.	Date:
-------	------	-------

Signature/Stamp:

Approval to Proceed: Date:

APPROVED
 By *Dan Trudgeon* (fminterr@uwo.ca) at 3:00 pm, Apr 13, 2016

Notes:

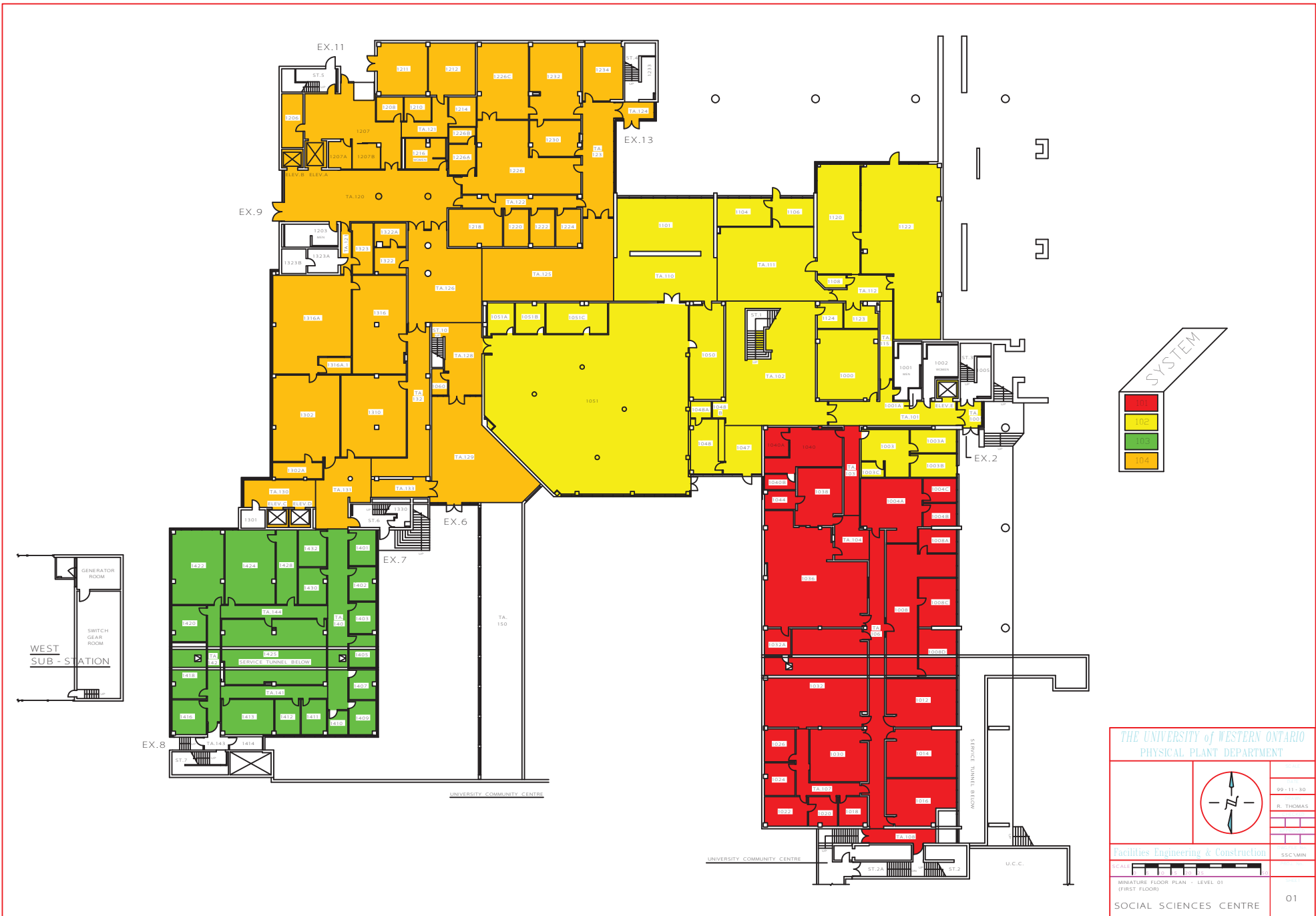

SYSTEM

- 101
- 102
- 103
- 104

THE UNIVERSITY of WESTERN ONTARIO
PHYSICAL PLANT DEPARTMENT

99-11-30
R. THOMAS

Facilities Engineering & Construction
SSC/MIN

MINIATURE FLOOR PLAN - LEVEL 01
(FIRST FLOOR)

SOCIAL SCIENCES CENTRE

01

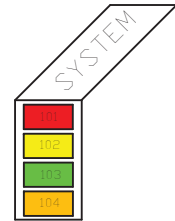

THE UNIVERSITY of WESTERN ONTARIO
PHYSICAL PLANT DEPARTMENT

50-04-06
R. THOMAS

Facilities Engineering & Construction
SSC/MIN

MINIATURE FLOOR PLAN - LEVEL 02
(SECOND FLOOR)

SOCIAL SCIENCES CENTRE

02

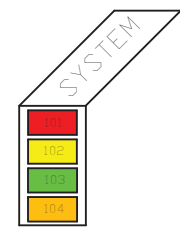

THE UNIVERSITY of WESTERN ONTARIO
PHYSICAL PLANT DEPARTMENT

50-02-09
R. THOMAS

Facilities Engineering & Construction
SSC/MIN

MINIATURE FLOOR PLAN - LEVEL 03
(THIRD FLOOR)

SOCIAL SCIENCES CENTRE

03

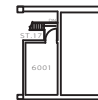
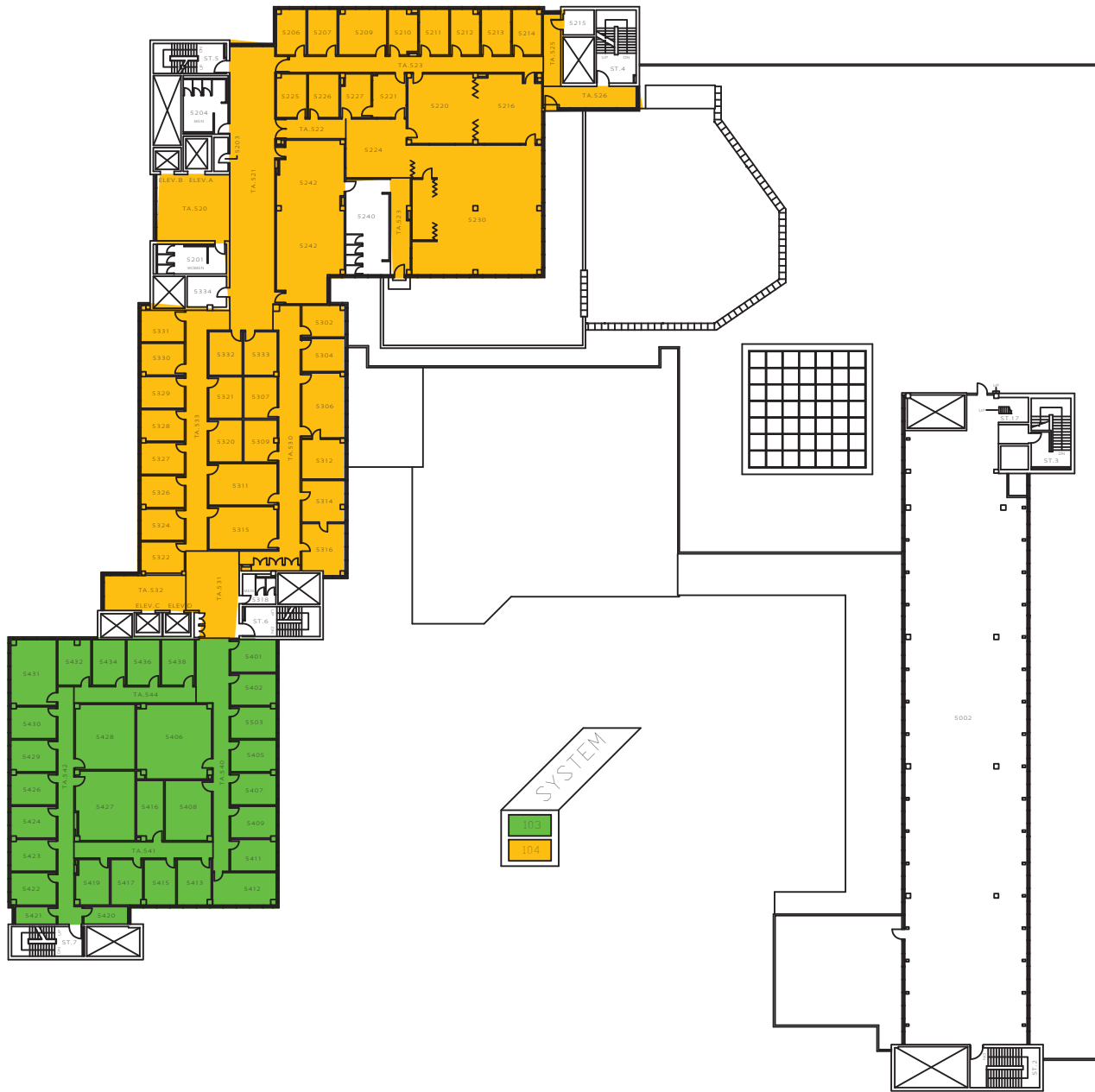

MACHINE ROOM
ELEV. 89' - 4"

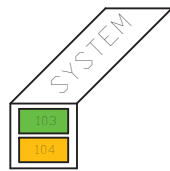

THE UNIVERSITY of WESTERN ONTARIO PHYSICAL PLANT DEPARTMENT	
	00-02-18
	S. PRENTICE
Facilities Engineering & Construction	SSC/MIN
SCALE:	
MINIATURE FLOOR PLAN - LEVEL 05 (FIFTH FLOOR)	05
SOCIAL SCIENCES CENTRE	

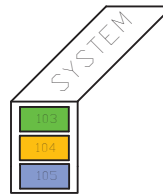
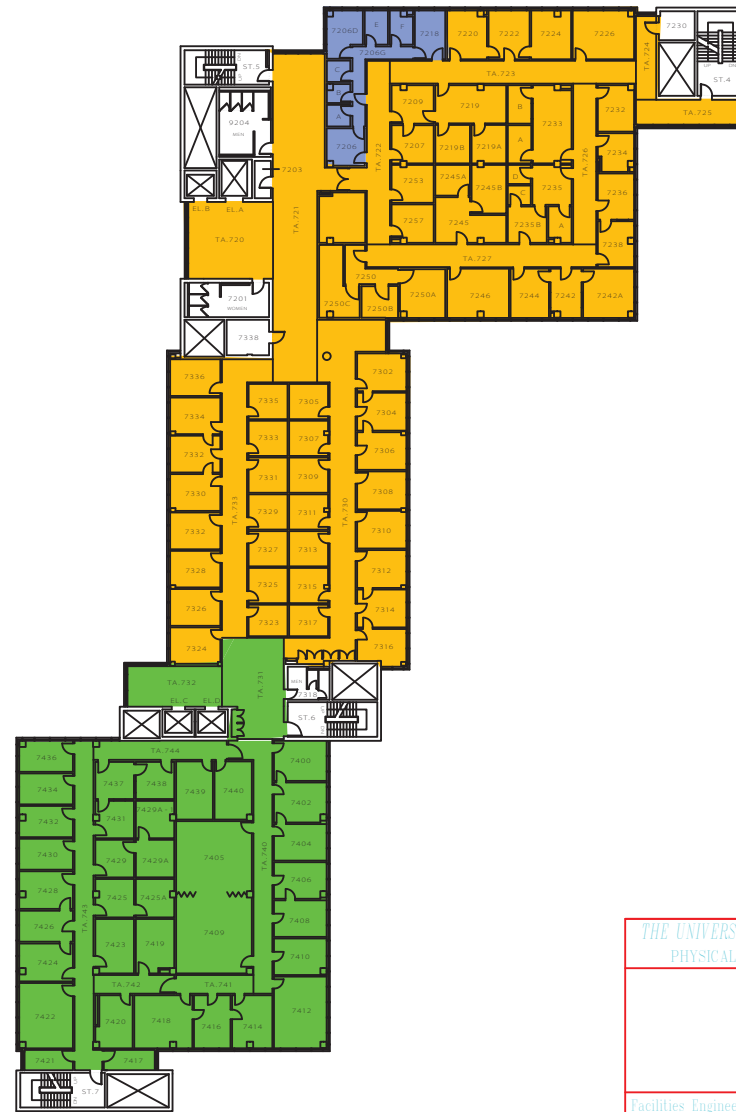
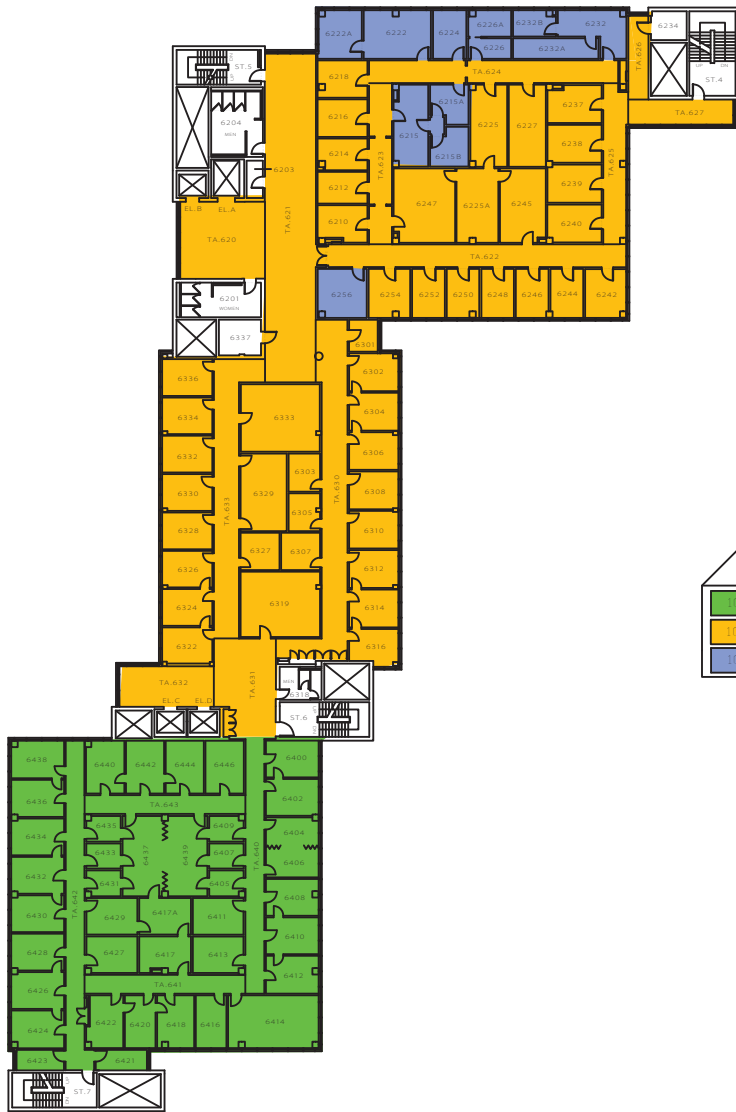

THE UNIVERSITY of WESTERN ONTARIO
PHYSICAL PLANT DEPARTMENT

00-03-31
B. THOMAS

Facilities Engineering & Construction

SCALE: 1:100

MINIATURE FLOOR PLANS - LEVELS 06 & 07
(6TH & 7TH FLOORS)

SOCIAL SCIENCES CENTRE

06

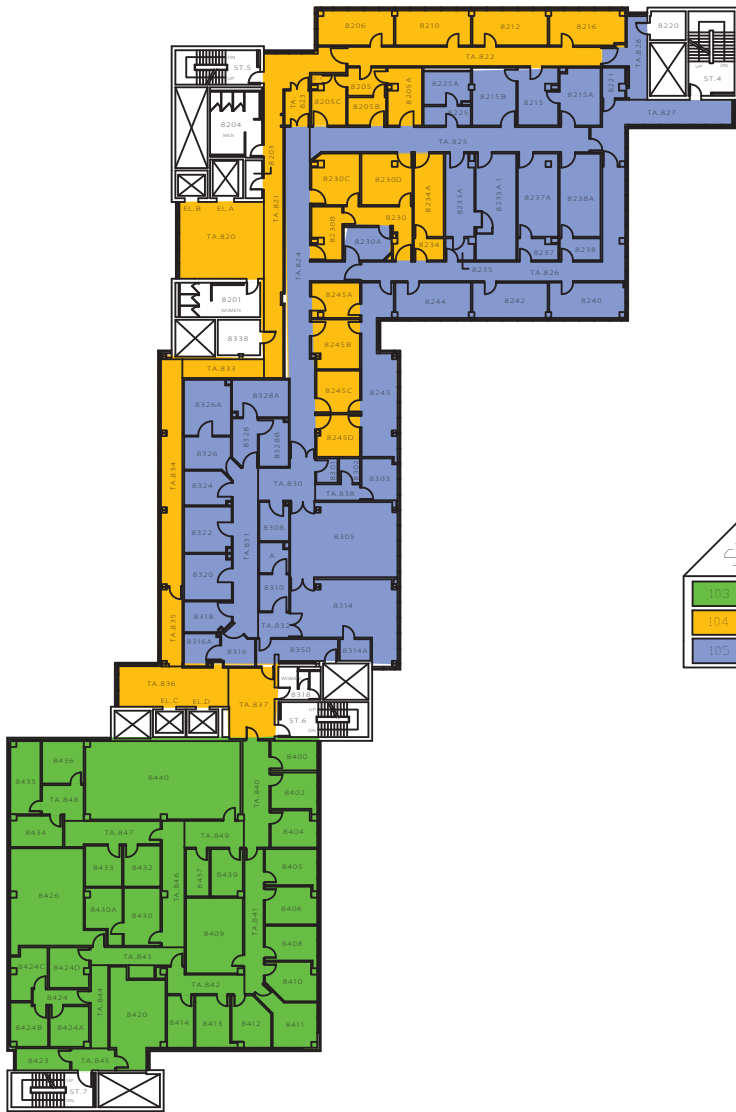

LEVEL 08

