



**Notice of Project  
Western University  
Facilities Management  
Client Services 519-661-3304 (fmhelp@uwo.ca)**

Submit by E-mail

Print Form

Project Number: <input type="text" value="9D7332"/>	<input checked="" type="checkbox"/> Miniature Attached	Date/Schedule: <input type="text" value="Aug 15-23, 2016"/>
Project Name: <input type="text" value="Catch Basin repairs on Kent Drive, east of UC"/>		Time: <input type="text" value="7:00am - 5:30pm"/>

Building(s) Affected: #1 <input type="text" value="Kent Drive"/>	#2 <input type="text" value="University College"/>
#3 <input type="text"/>	#4 <input type="text"/>
Areas/Rooms Affected, Alternate Route/Service: <input type="text" value="2 isolated areas of sinkhole hazards to be repaired"/>	

Service to be interrupted: #1 <input type="text" value="Parking Lot spaces along east edge of Kent Drive at UC Hill"/>	#2 <input type="text"/>
#3 <input type="text"/>	#4 <input type="text"/>
Description/Reason for Project: <input type="text" value="Removal of sunken, and broken asphalt, replace roadbase granular, parge extg CB's and connect to existing storm system, backfill same area, pave of long narrow area Southbound lane) Refer to attached map."/>	

Project Manager/Co-ordinator: <input type="text" value="Craig Fellner"/>	Phone # <input type="text" value="82711"/>	Cell # <input type="text" value="+1 (519) 808-9512"/>
Signature/Stamp: <input type="text"/>	Client Contact: <input type="text" value="n/a civil work under capital"/>	Phone # <input type="text" value="82711"/>
	Designer Consultant: <input type="text" value="n/a no design req'd"/>	

Contractor: <input type="text" value="Aar-Con Excavating inc. Adrian is supt."/>	Cell # <input type="text" value="519-521-5586"/>
--	--

Emergency Phone List: (to CCPS Only)     Attached     To Follow

Special Conditions ( Noise, Odors, Asbestos, Etc.)

Asbestos     Type 3     Type 2     Type 1     Contractor     In House Team     Other  
 Information Sheet Sent To Client

Comments:

**Shutdowns/Interruptions(Approximate Schedule):**

Electrical Power <input type="checkbox"/>	Date: _____	Elevators <input type="checkbox"/>	Date: _____	ITS <input type="checkbox"/>	Date: _____
Domestic Water <input type="checkbox"/>	Date: _____	Fire Alarms <input type="checkbox"/>	Date: _____	Other <input type="checkbox"/>	Date: _____
Steam <input type="checkbox"/>	Date: _____	Chilled Water <input type="checkbox"/>	Date: _____		
Hot Water Heating <input type="checkbox"/>	Date: _____	Roads / Lots <input type="checkbox"/>	Date: _____		

Issued By:	<b>APPROVED</b>	Date: <input type="text"/>
Signature/Stamp:	<i>By Justin DeGurse (jdegurs3@uwo.ca) at 2:06 pm, Aug 12, 2016</i>	Date: <input type="text"/>

Note:

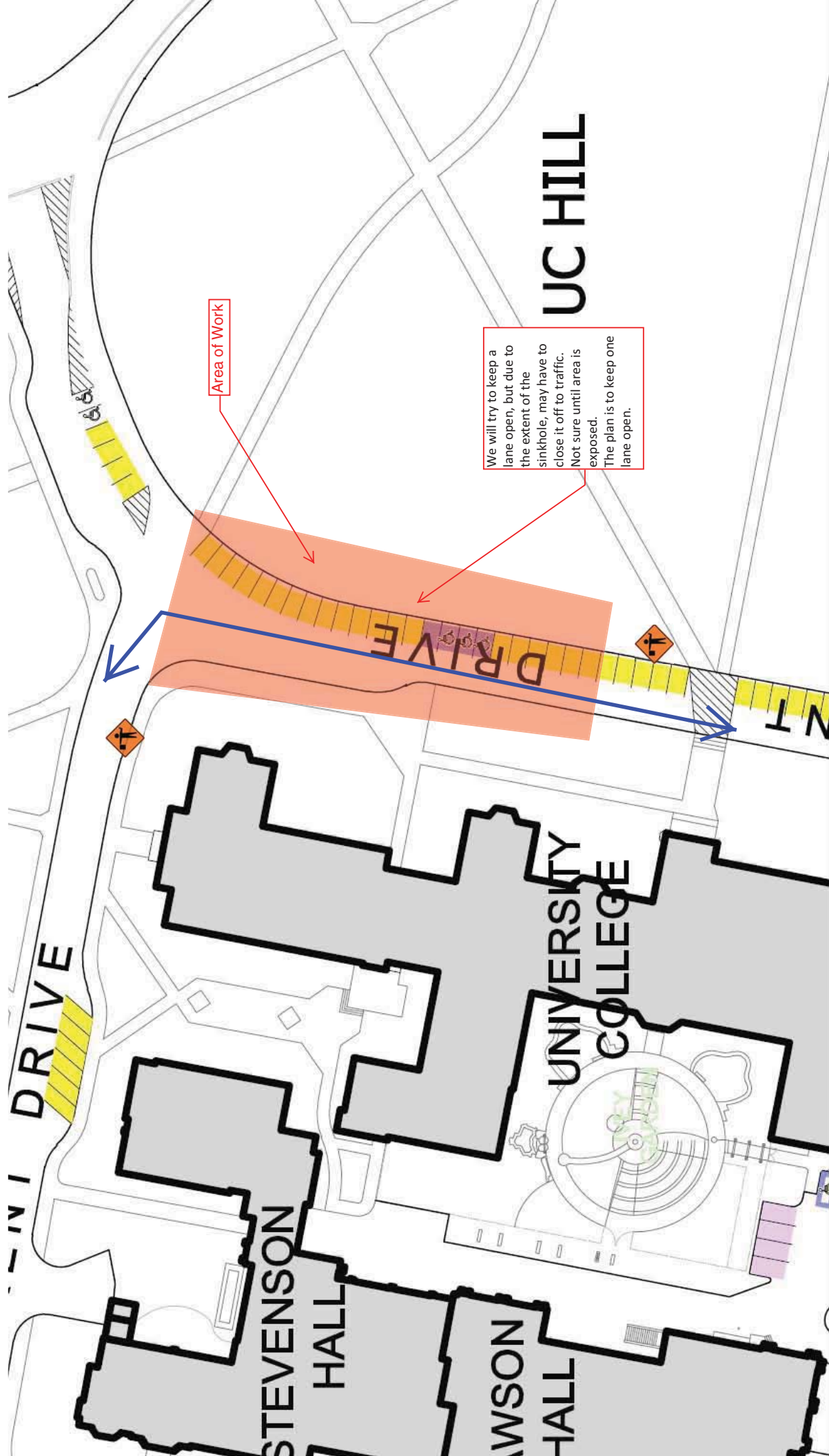

# UC HILL

Area of Work

We will try to keep a lane open, but due to the extent of the sinkhole, may have to close it off to traffic. Not sure until area is exposed. The plan is to keep one lane open.

UC HILL DRIVE

STEVENSON HALL

STEVENSON HALL

UNIVERSITY COLLEGE

UC HILL DRIVE

UC HILL DRIVE