



**Notice of Project  
Western University  
Facilities Management  
Client Services 519-661-3304 (fmhelp@uwo.ca)**

Submit by E-mail

Print Form

Project Number:   Miniature Attached      Date/Schedule:

Project Name:       Time:

Building(s) Affected: #1  #2   
 #3  #4

Areas/Rooms Affected, Alternate Route/Service:

Service to be interrupted: #1  #2   
 #3  #4

Description/Reason for Project:

Project Manager/Co-ordinator:  Phone #  Cell #

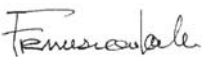
Signature/Stamp:   Client Contact:  Phone #

Designer Consultant:

Contractor:  Cell #

Emergency Phone List: (to CCPS Only)       Attached       To Follow

Special Conditions ( Noise, Odors, Asbestos, Etc.)

Asbestos     Type 3     Type 2     Type 1     Contractor     In House Team     Other  
 Information Sheet Sent To Client

Comments:

Shutdowns/Interruptions(Approximate Schedule):

Electrical Power <input type="checkbox"/>	Date: _____	Elevators <input type="checkbox"/>	Date: _____	ITS <input type="checkbox"/>	Date: _____
Domestic Water <input type="checkbox"/>	Date: _____	Fire Alarms <input type="checkbox"/>	Date: _____	Other <input type="checkbox"/>	Date: _____
Steam <input type="checkbox"/>	Date: _____	Chilled Water <input type="checkbox"/>	Date: _____		
Hot Water Heating <input type="checkbox"/>	Date: _____	Roads / Lots <input type="checkbox"/>	Date: _____		

Issued By:  Date:

Signature/Stamp:  Date:

Note:

No access in this area on December 21st

No access in this area on December 22nd

No access in this area on December 23rd

No access in this area on December 20th

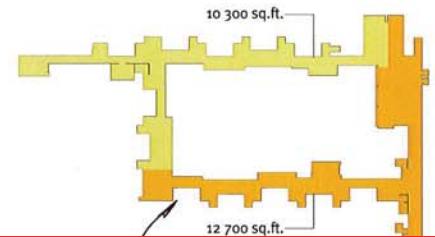

SOUTH ENTRANCE - LIMESTONE TILE WILL BE REMOVED TO INSTALL NEW CARPET. SOUTH ENTRANCE WILL BE CLOSED STARTING DECEMBER 21ST - DECEMBER 27TH

No access in this area on December 27th

No access in this area on December 24th

Ground Level Stone Flooring Diagram

Richard Ivey School of Business, University of Western Ontario  
Coordination  
09.11.25

HARIRI PONTARINI  
ARCHITECTS

scale 1:750