



Notice of Service Interruption/Area Closure
Western University
Facilities Management
Client Services 519-661-3304 (fmhelp@uwo.ca)

Submit by E-mail
 Print Form

Date of Interruption/Closure: Time(s):

Building(s) Affected: #1 #2
 #3 #4
 Areas/Rooms Affected Alternate Route/Service:

Service to be interrupted: #1 #2
 #3 #4
 Description/Reason for Project:

Requester: Date of Request:

Supervising Tradesperson: Unit:
 Trade Manager: Unit: Date:

Contractor: Phone #:
 Coordinator/Project Manager: Phone #: Date:

Reviewed by Trade Manager(s)/Shop(s) Affected:

Name:	Date:	Name: WES Control	Date: Jun 5, 2017
Signature/Stamp:		Signature/Stamp: REVIEWED <i>By Wayne Drummond (ppdwad@uwo.ca) at 1:48 pm, Jun 05, 2017</i>	

Principal Occupants:

Name:	Ext.:	Date:
Name:	Ext.:	Date:
Name:	Ext.:	Date:
Name:	Ext.:	Date:

Approval to Proceed: Date:

APPROVED
By Dara Gomez (dgomez5@uwo.ca) at 7:18 am, Jun 06, 2017

Notes:

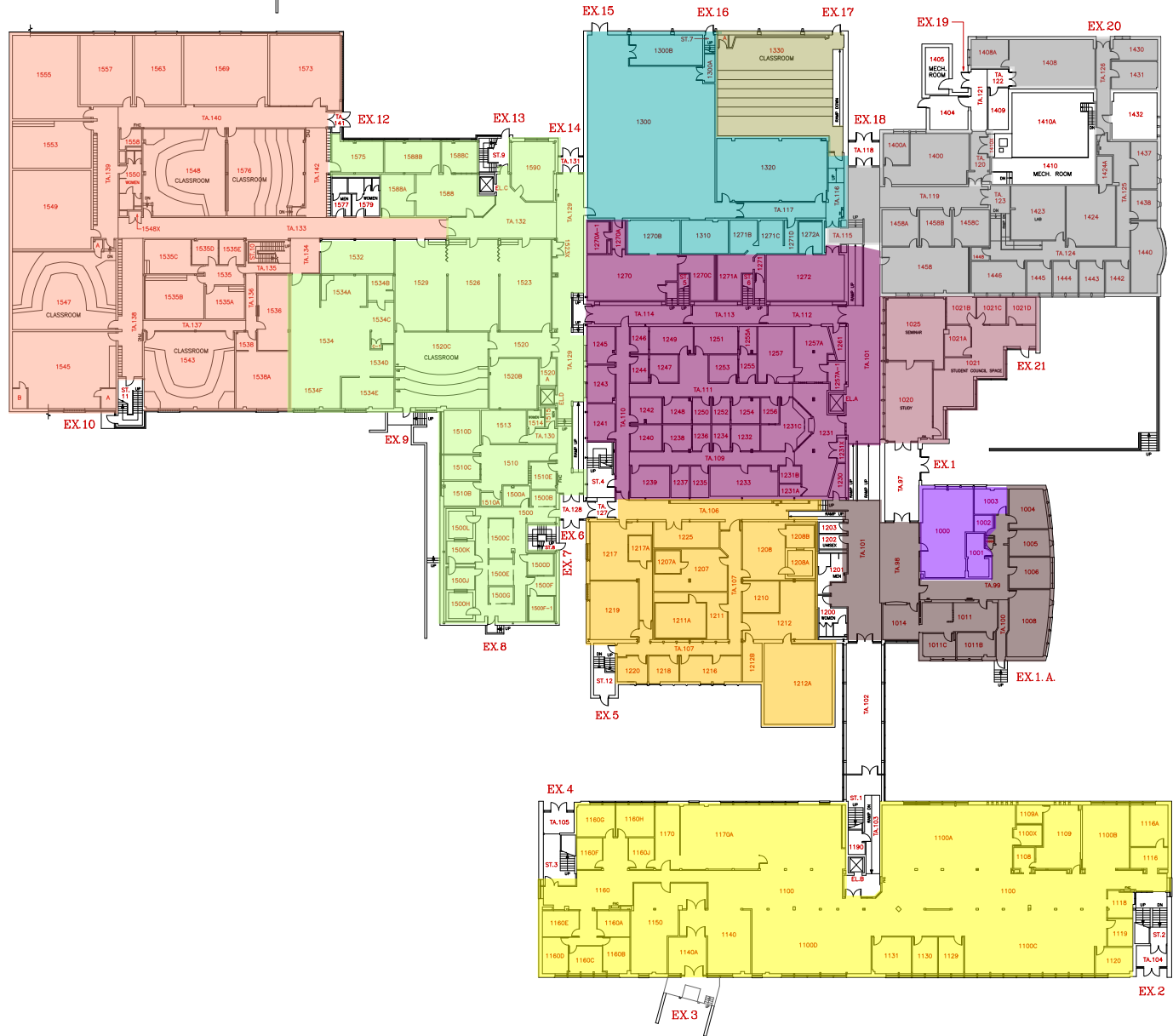

SYSTEM 102	Yellow
SYSTEM 104	Orange
SYSTEM 106	Grey
SYSTEM 107	Light Blue
SYSTEM 108	Dark Blue
SYSTEM 109	Purple
SYSTEM 111	Green
SYSTEM 112	Light Green
SYSTEM 114	Brown
SYSTEM 115	Dark Green
SYSTEM 119	Dark Purple

Western
UNIVERSITY OF CANADA

BUILDING NORTH

FACILITIES MANAGEMENT

SCALE: 0 10 20 30 40 50 60

BUILDING FLOOR PLAN - LEVEL 01
(FIRST FLOOR PLAN)

ELBORN COLLEGE

DATE: 2016-08-15
DRAWN: S. THOMAS
CHECKED:
APPROVED:
DESIGNED BY: EC-01
GEOMETRIC ELEVATION:
WAVES:

01