



**Notice of Service Interruption/Area Closure**  
**Western University**  
**Facilities Management**  
**Client Services 519-661-3304 (fmhelp@uwo.ca)**

Submit by E-mail  
 Print Form

**REVISED**  
 9:08 am, May 19, 2016

Date of Interruption/Closure: **May 3rd - June 10th, 2016** Time(s): **24/7**

Building(s) Affected: #1 **ELBORN COLLEGE (EC)** #2   
 #3  #4

Areas/Rooms Affected Alternate Route/Service:  
 See attached for rooms effected.

Service to be interrupted: #1 **Supply Air Fan** #2 **Return Air Fan**  
 #3  #4

Description/Reason for Project:  
 AHU's #104, 106 & 100 will be shutdown due to Type 3 asbestos removal in Corr TA.101. Asbestos containing pipe insulation will be removed in this corridor ventilation will need to be shutdown.

Requester: **Leo Salvo** Date of Request: **Apr 27, 2016**

Supervising Tradesperson:  Unit:

Trade Supervisor:  Unit:  Date:

Contractor: **Besterd Mechanical - Rob Littlechild** Phone # **+1 (519) 639-1204**

Coordinator/Project Manager: **Leo Salvo** Phone # **+1 (519) 520-8969** Date: **Apr 27, 2016**

Reviewed by Trade Supervisor(s)/Shop(s) Affected:  
 Name: **Electrical / Mechanical Shop** Date: **Apr 27, 2016**  
 Name: **WES Control** Date: **Apr 27, 2016**

Signature/Stamp: **APPROVED**  
 By **Steve MacKay (smackay@uwo.ca)** at **4:03 pm, Apr 28, 2016**

Signature/Stamp: **REVIEWED**  
 By **Wayne Drummond (ppdwad@uwo.ca)** at **11:09 am, Apr 28, 2016**

Name:  Date:

Principal Occupants:  

Name:	Ext.	Date:
Name:	Ext.	Date:
Name:	Ext.	Date:
Name:	Ext.	Date:

Signature/Stamp:

Approval to Proceed:  Date:

Signature/Stamp:

Signature/Stamp: **APPROVED**  
 By **Dan Trudgeon (dtrudgeo@uwo.ca)** at **4:05 pm, Apr 28, 2016**

Notes: **W/O 568389 associated with this S.I.**

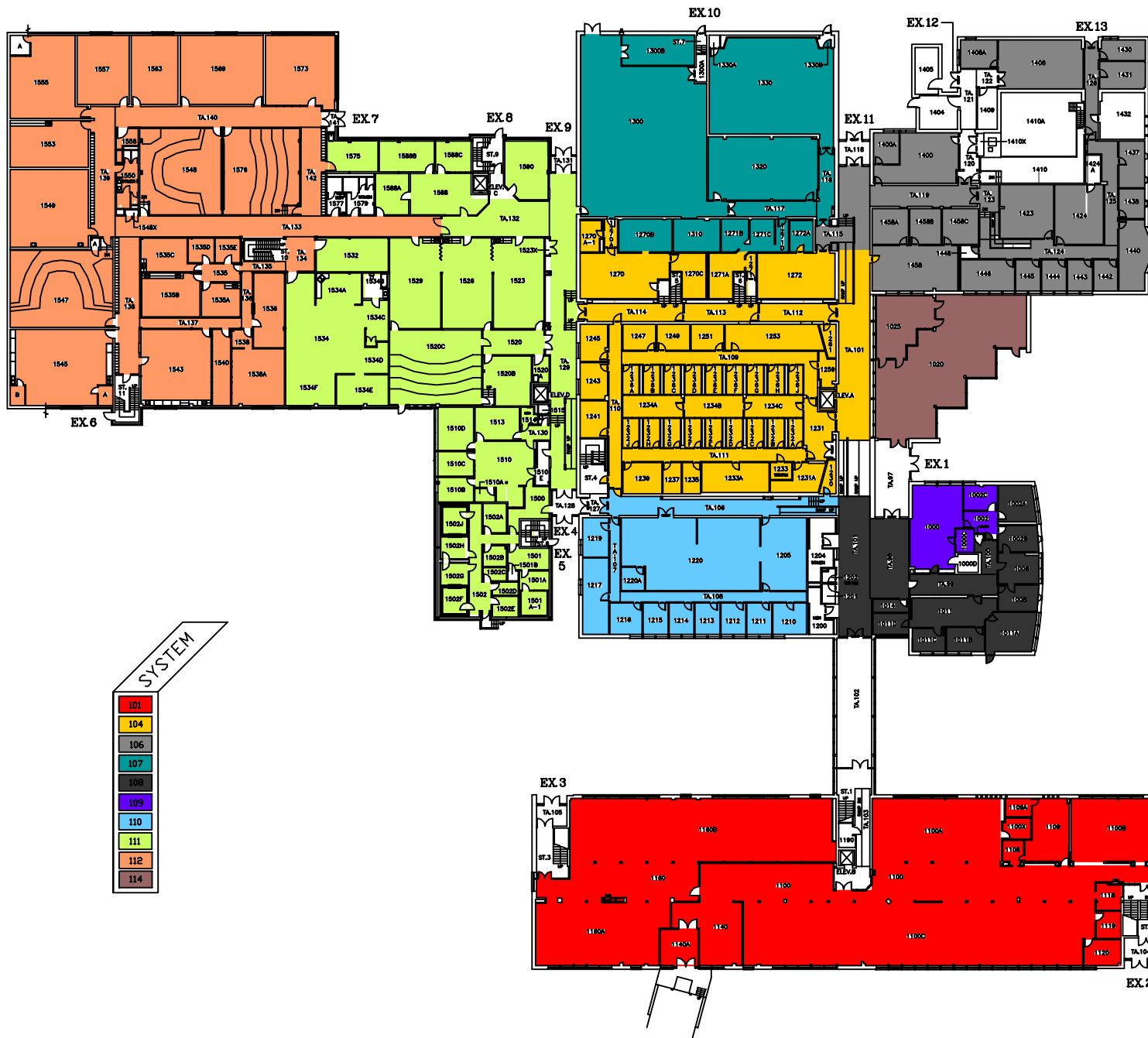

SYSTEM	
101	Red
104	Yellow
106	Grey
107	Teal
108	Dark Grey
109	Purple
110	Light Blue
111	Light Green
112	Orange
114	Dark Green

**THE UNIVERSITY of WESTERN ONTARIO**  
**PHYSICAL PLANT DEPARTMENT**

SCALE: 1/8" = 1'-0"

DATE: 09-04-28

BY: R. THOMAS

CHECKED: [Signature]

Facilities Engineering & Construction

SCALE: 1/8" = 1'-0"

DATE: 09-04-28

BY: R. THOMAS

CHECKED: [Signature]

ELBORN COLLEGE

01



**THE UNIVERSITY of WESTERN ONTARIO**  
**PHYSICAL PLANT DEPARTMENT**

	SCALE
	DATE 09-04-28
	DESIGNED BY R. THOMAS
	CHECKED BY [Signature]

Facilities Engineering & Construction  
 SCALE: 1/8" = 1'-0" (AS SHOWN)  
 DRAWING NO. 02