



Notice of Service Interruption/Area Closure
Western University
Facilities Management
Client Services 519-661-3304 (fmhelp@uwo.ca)

Submit by E-mail
 Print Form

Date of Interruption/Closure: Time(s):

Building(s) Affected: #1 #2
 #3 #4

Areas/Rooms Affected Alternate Route/Service:

Service to be interrupted: #1 #2
 #3 #4

Description/Reason for Project:

Requester: Date of Request:

Supervising Tradesperson: Unit:

Trade Supervisor: Unit: Date:

Contractor: Phone #:

Coordinator/Project Manager: Phone #: Date:

Reviewed by Trade Supervisor(s)/Shop(s) Affected:

Name: <input type="text" value="Plumber/Fitter Shop"/>	Date: <input type="text" value="Oct 21, 2014"/>	Name: <input type="text"/>	Date: <input type="text" value="Oct 21, 2014"/>
Signature/Stamp: <input type="text" value="APPROVED
By Carmen Bertone (cbertone@uwo.ca) at 1:36 pm, Oct 21, 2014"/>		Signature/Stamp: <input type="text"/>	
Name: <input type="text"/>	Date: <input type="text"/>	Principal Occupants:	
Signature/Stamp: <input type="text"/>		Name: <input type="text"/>	Ext. <input type="text"/> Date: <input type="text"/>
Name: <input type="text"/>	Date: <input type="text"/>	Name: <input type="text"/>	Ext. <input type="text"/> Date: <input type="text"/>
Signature/Stamp: <input type="text"/>		Name: <input type="text"/>	Ext. <input type="text"/> Date: <input type="text"/>
Name: <input type="text"/>	Date: <input type="text"/>	Name: <input type="text"/>	Ext. <input type="text"/> Date: <input type="text"/>
Signature/Stamp: <input type="text"/>		Approval to Proceed: <input type="text"/> Date: <input type="text"/>	
Name: <input type="text"/>	Date: <input type="text"/>	APPROVED By Dan Trudgeon (fminterr@uwo.ca) at 2:42 pm, Oct 21, 2014	
Signature/Stamp: <input type="text"/>			

Notes:

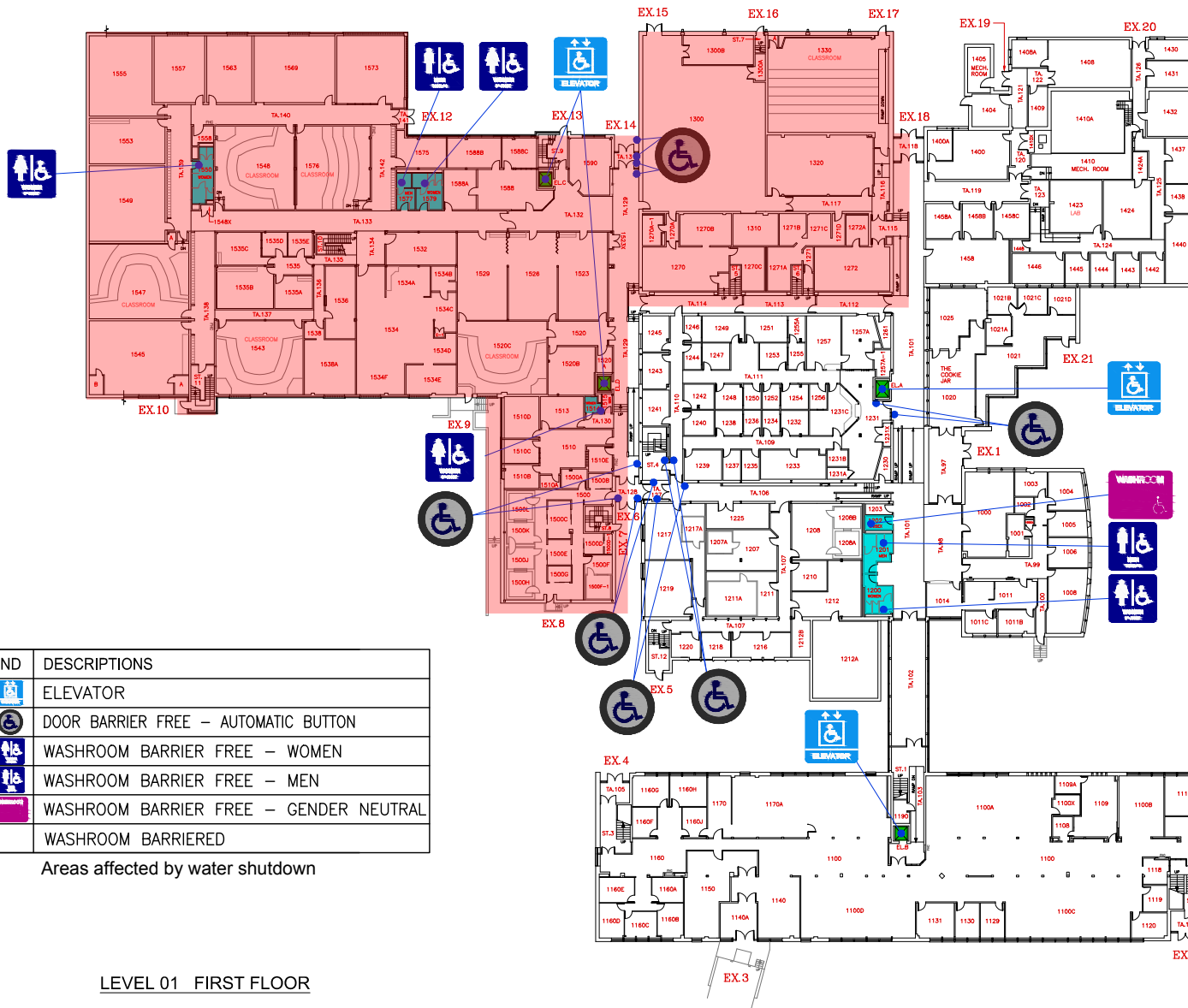

LEGEND	DESCRIPTIONS
	ELEVATOR
	DOOR BARRIER FREE – AUTOMATIC BUTTON
	WASHROOM BARRIER FREE – WOMEN
	WASHROOM BARRIER FREE – MEN
	WASHROOM BARRIER FREE – GENDER NEUTRAL
	WASHROOM BARRIERED

Areas affected by water shutdown

LEVEL 01 FIRST FLOOR

ACCESSIBILITY WESTERN FLOOR PLAN
LEVEL 1 / FIRST FLOOR / ELBORN COLLEGE

FACILITIES MANAGEMENT
SUPPORT SERVICES BUILDING
Level 2 Lower building Rm.2350
1393 WESTERN ROAD N6G-1G9

UPDATE
05/02/2012
DRAWN



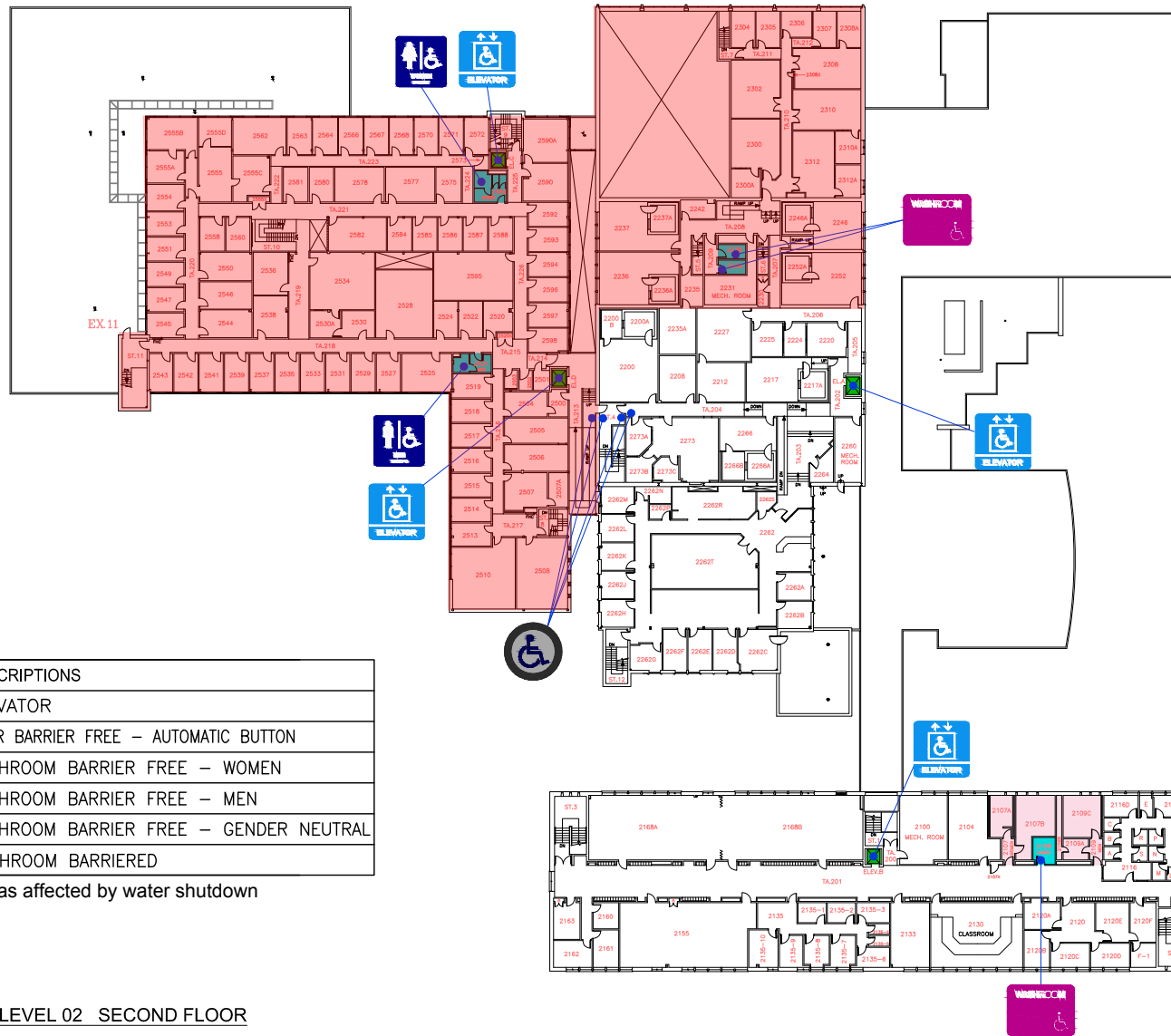

LEGEND	DESCRIPTIONS
	ELEVATOR
	DOOR BARRIER FREE – AUTOMATIC BUTTON
	WASHROOM BARRIER FREE – WOMEN
	WASHROOM BARRIER FREE – MEN
	WASHROOM BARRIER FREE – GENDER NEUTRAL
	WASHROOM BARRIERED
	Areas affected by water shutdown

LEVEL 02 SECOND FLOOR

ACCESSIBILITY WESTERN FLOOR PLAN
LEVEL 2 / SECOND FLOOR / ELBORN COLLEGE

FACILITIES MANAGEMENT
SUPPORT SERVICES BUILDING
Level 2 Lower building Rm.2350
1393 WESTERN ROAD N6G-1G9

UPDATE
05/02/2012
DRAWN

