



Notice of Service Interruption/Area Closure
Western University
Facilities Management
Client Services 519-661-3304 (fmhelp@uwo.ca)

Submit by E-mail
 Print Form

REVISED
 3:20 pm, Jun 19, 2018

Date of Interruption/Closure Time(s):

Building(s) Affected: #1 #2
 #3 #4
 Areas/Rooms Affected Alternate Route/Service:

Areas served by Fan 101, 102, 103, 104, 113. See attached HVAC drawings.

Service to be interrupted: #1 #2
 #3 #4

Description/Reason for Project:

Requester: Date of Request:

Supervising Tradesperson: Unit:

Trade Manager: Unit: Date:

Contractor: Phone #

Coordinator/Project Manager: Phone # Date:

Reviewed by Trade Manager(s)/Shop(s) Affected:

Name: <input type="text" value="Electrical / Mechanical Shop"/>	Date: <input type="text" value="May 29, 2018"/>	Name: <input type="text" value="WES Control"/>	Date: <input type="text"/>
---	---	--	----------------------------

Signature/Stamp:

Signature/Stamp:
By Wayne Drummond (ppdwad@uwo.ca) at 8:59 am, May 30, 2018

Name: Date:

Principal Occupants:

Signature/Stamp:

Name: <input type="text"/>	Ext. <input type="text"/>	Date: <input type="text"/>
----------------------------	---------------------------	----------------------------

Name: Date:

Name: <input type="text"/>	Ext. <input type="text"/>	Date: <input type="text"/>
----------------------------	---------------------------	----------------------------

Signature/Stamp:

Name: <input type="text"/>	Ext. <input type="text"/>	Date: <input type="text"/>
----------------------------	---------------------------	----------------------------

Name: Date:

Name: <input type="text"/>	Ext. <input type="text"/>	Date: <input type="text"/>
----------------------------	---------------------------	----------------------------

Signature/Stamp:

Approval to Proceed: Date:

APPROVED
 By Dara Gomez at 11:30 am, May 30, 2018

Notes:



BASEMENT FLOOR

787.88 FT.

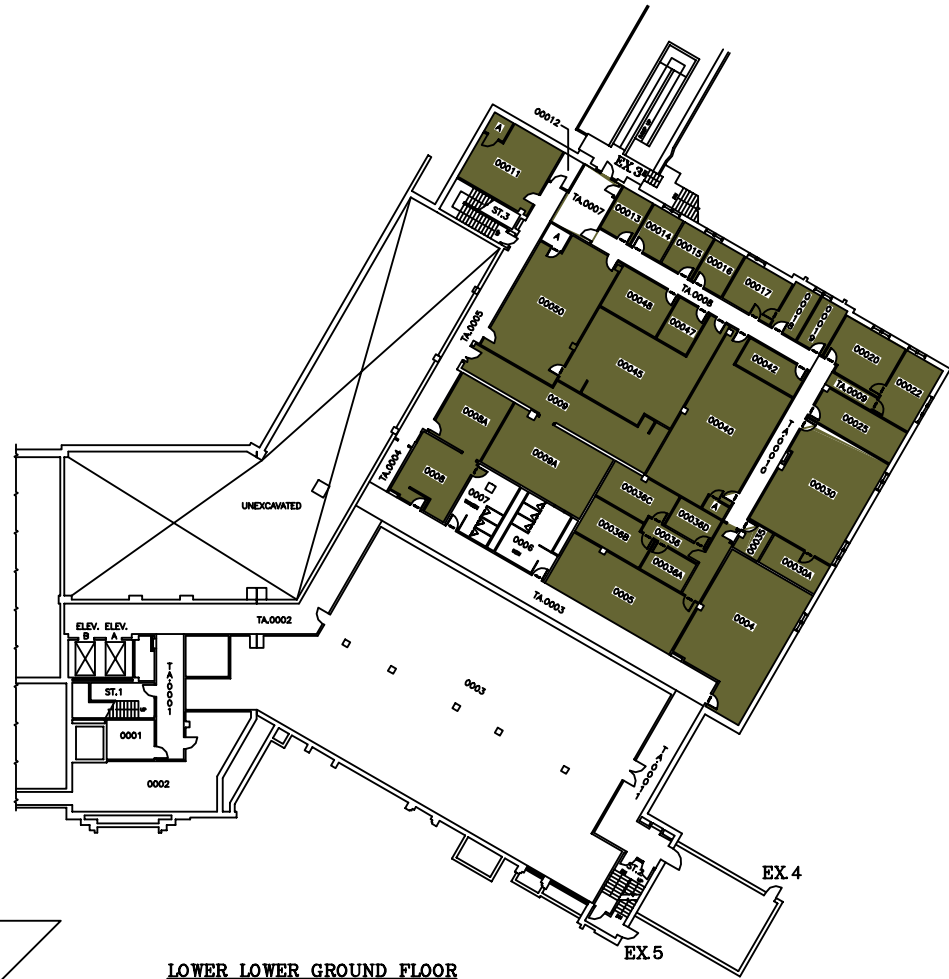

LOWER LOWER GROUND FLOOR

798.89 FT.

SYSTEM	ZONE #
113	A
114	B
	C

THE UNIVERSITY of WESTERN ONTARIO
PHYSICAL PLANT DEPARTMENT

SCALE: Varies
 DATE: W8-01-28
 DRAWN BY: R. THOMAS
 CHECKED BY: []
 APPROVED BY: []
 DESIGNED BY: DSB/MIN
 SCALE: 1" = 10'-0"

Facilities Engineering & Construction

MINIATURE FLOOR PLAN - LEVELS 01 & 02
 (BASEMENT & LOWER LOWER GROUND FLOORS)

DENTAL SCIENCES BLDG.

SCALE: 1" = 10'-0"

DATE: W8-01-28

DRAWN BY: R. THOMAS

CHECKED BY: []

APPROVED BY: []

DESIGNED BY: DSB/MIN

SCALE: VARIES

01

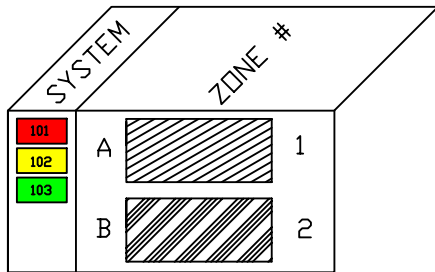

EX 1

FAN 101, 102, 103, 104 & 113
NEED TO BE SHUTDOWN
WHEN WORK IN THE
CEILING IS REQUIRED
(SUPPLY & RETURN)

THE UNIVERSITY of WESTERN ONTARIO PHYSICAL PLANT DEPARTMENT	
	SCALE 98-09-11 DATE R. THOMAS CHECKED APPROVED SHELFLE No. DSB\MIN
	GEOMETRIC ELEV. 812.80 FT.
Facilities Engineering & Construction	
SCALE: 1" = 10' 1" 2" 3" 4" 5" 6" 8" 10" 12" 15" 20" 25" 30"	
MINUTURE FLOOR PLAN - LEVEL 03 (LOWER GROUND FLOOR)	
DENTAL SCIENCES BLDG.	
02	

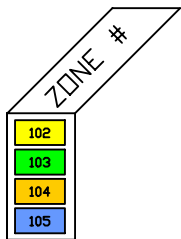
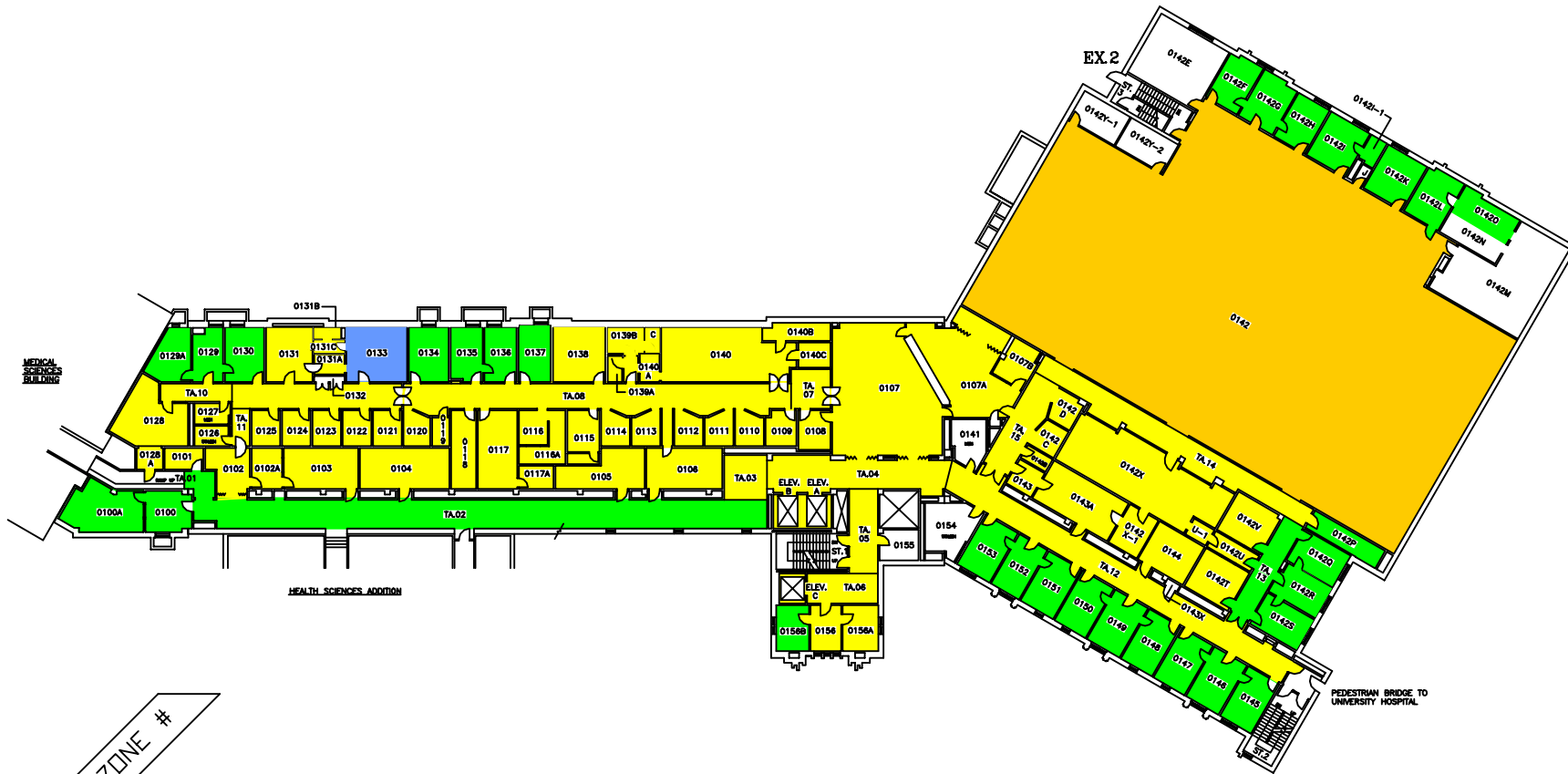

THE UNIVERSITY of WESTERN ONTARIO
PHYSICAL PLANT DEPARTMENT

	SCALE
	DATE 98-01-21
	DRAWN BY R. THOMAS
	CHECKED BY [Signature]
Facilities Engineering & Construction	
SCALE 1" = 10' 15" 20' 30' 40' 50'	GEOMETRIC ELEV. 828.86 FT.
MINATURE FLOOR PLAN - LEVEL 04 (GROUND FLOOR)	
DENTAL SCIENCES BLDG.	
03	

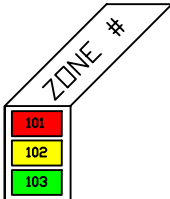

THE UNIVERSITY OF WESTERN ONTARIO
PHYSICAL PLANT DEPARTMENT



Facilities Engineering & Construction

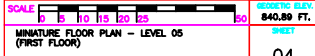

MINIATURE FLOOR PLAN - LEVEL 05
(FIRST FLOOR)

DENTAL SCIENCES BLDG. 04

SCALE	1" = 100 FT.
DATE	98-08-08
DRAWN BY	R. THOMAS
CHECKED BY	
APPROVED BY	
PROJECT No.	
DRAWING No.	DSB/MIN
GEOMETRIC ELEV.	840.88 FT.
SHEET	04



SYSTEM	ZONE #
101	F
102	G
103	H
	I

THE UNIVERSITY of WESTERN ONTARIO
PHYSICAL PLANT DEPARTMENT

	SCALE
	DATE 98-08-08
	DRAWN BY R. THOMAS
	CHECKED
	APPROVED

Facilities Engineering & Construction

SCALE 1" = 10' 1/8" 1/2" 1" 2" 4" 8" 16" 32"	GRAPHIC ELEV. 854.86 FT.
---	-----------------------------

MINIATURE FLOOR PLAN - LEVEL 06
(SECOND FLOOR)

DENTAL SCIENCES BLDG. 05

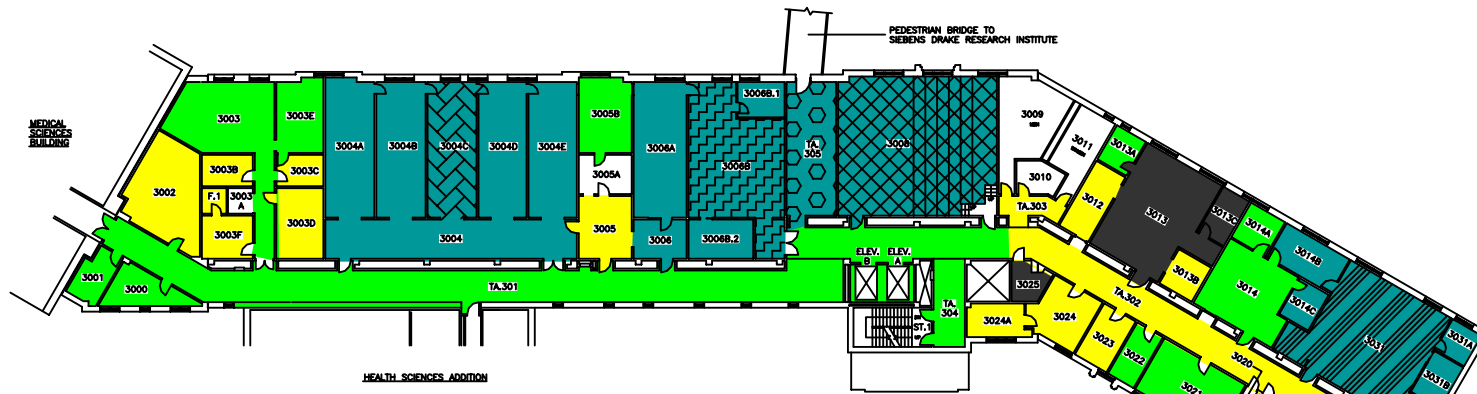

THIRD FLOOR

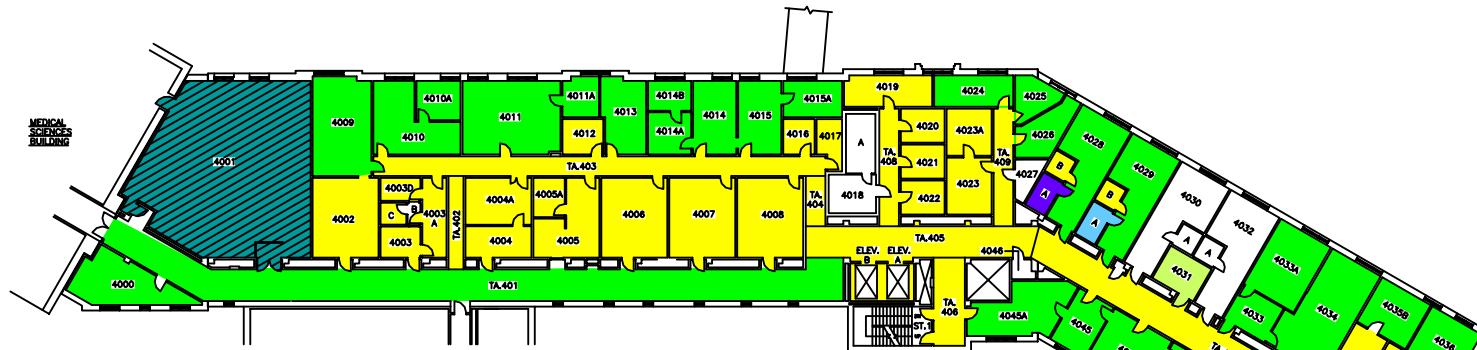

FOURTH FLOOR

SYSTEM	ZONE #
102	A
103	B
107	C
108	D
109	E
110	F
111	

THE UNIVERSITY of WESTERN ONTARIO
PHYSICAL PLANT DEPARTMENT

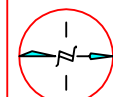

Facilities Engineering & Construction

SCALE: 1" = 10' 0" (30.48m)
MINIATURE FLOOR PLANS - LEVELS 07 & 08
(3RD AND 4TH FLOORS)

DENTAL SCIENCES BLDG.

SCALE: 1" = 10' 0" (30.48m)
DATE: 98-01-22
DRAWN BY: R. THOMAS
CHECKED BY: []
APPROVED BY: []
DWG FILE NO: DSB/MIN
GEOMETRIC ELEV.: VARIES
SHEET: 06

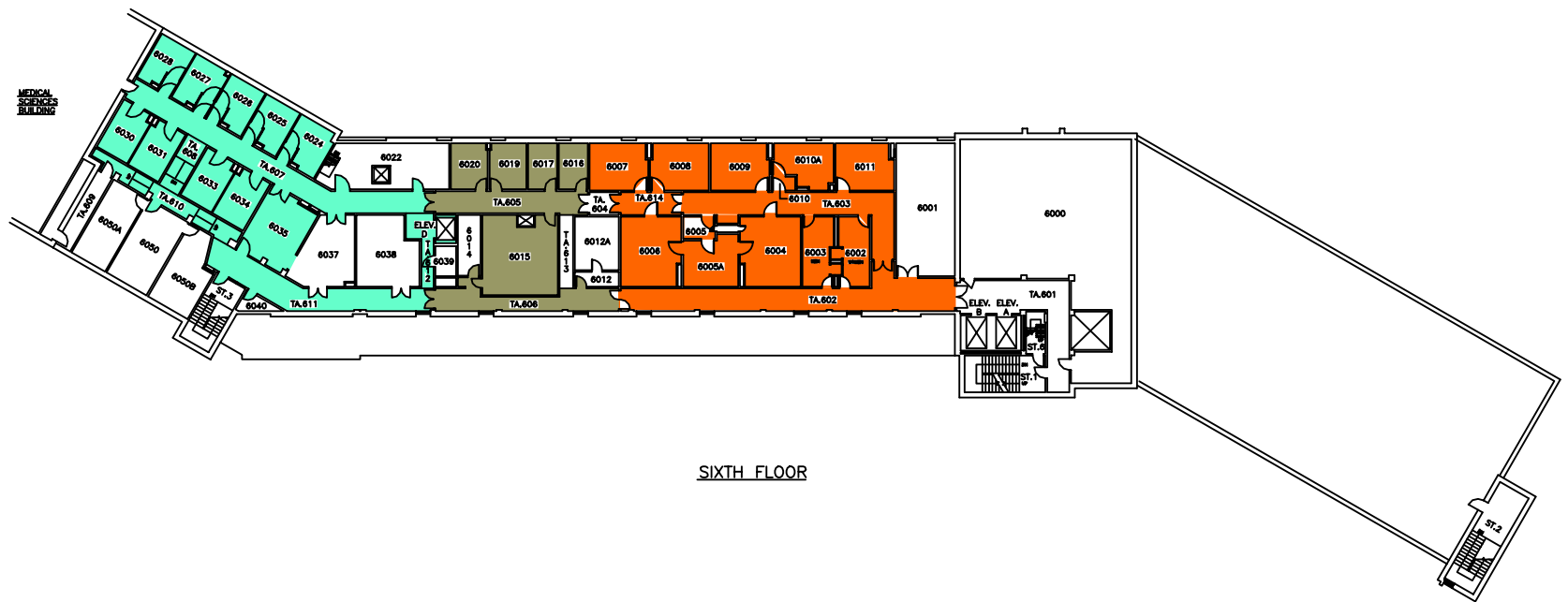

SIXTH FLOOR

ZONE #

102
103
106
108
115
116
117
102/103

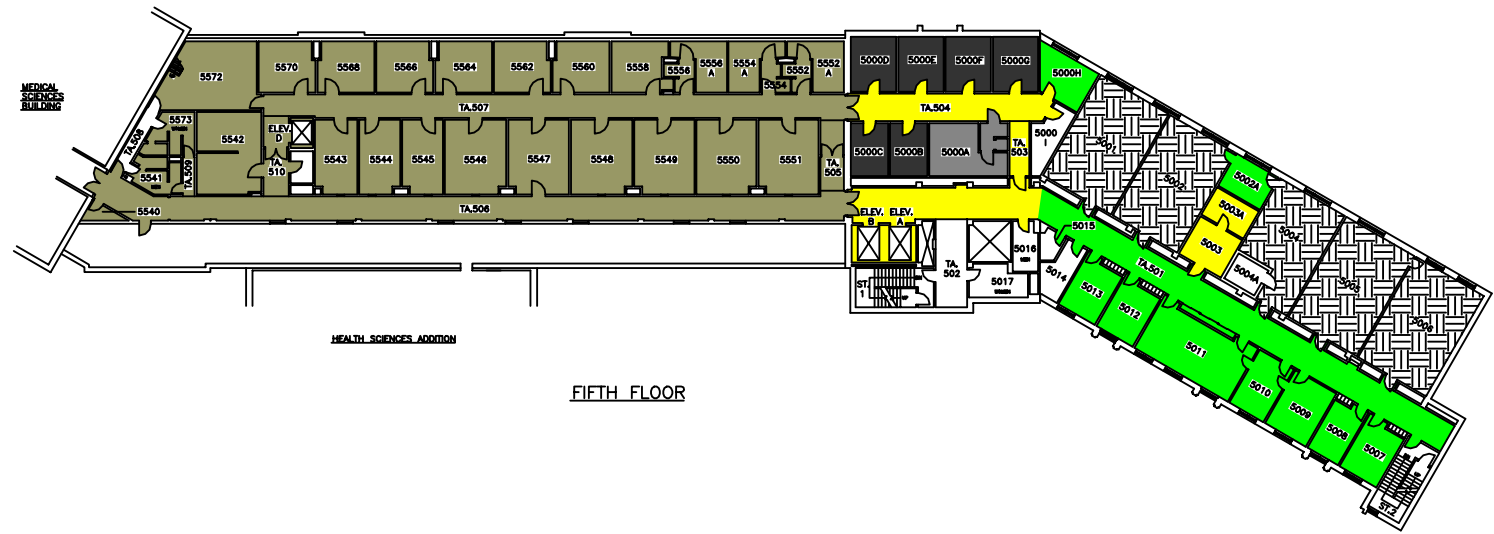

FIFTH FLOOR

THE UNIVERSITY of WESTERN ONTARIO
PHYSICAL PLANT DEPARTMENT

	<p>SCALE</p> <p>DATE 98-01-21</p> <p>DRAWN R. THOMAS</p> <p>CHECKED</p> <p>APPROVED</p> <p>DESIGNED BY DSB/MIN</p> <p>GEOMETRIC LEVEL VARIES</p>
<p>Facilities Engineering & Construction</p> <p>SCALE 150</p> <p>MINIATURE FLOOR PLANS - LEVELS 09 & 10 (5TH AND 6TH FLOORS)</p> <p>DENTAL SCIENCES BLDG.</p>	
<p>07</p>	