



Notice of Service Interruption/Area Closure
Western University
Facilities Management
Client Services 519-661-3304 (fmhelp@uwo.ca)

Submit by E-mail
 Print Form

Date of Interruption/Closure: Time(s):

Building(s) Affected: #1 #2
 #3 #4

Areas/Rooms Affected Alternate Route/Service:
 All rooms served by fan 101,103,104 & 113. Traffic area 103. See attached prints for affected areas.

Service to be interrupted: #1 #2
 #3 #4

Description/Reason for Project:
 Repair required for leaking hot water main supply line. Isolation valves not holding requiring a building shutdown of hot & cold water as well as supply fans listed. An asbestos tent is erected in TA 103 in front of room 1003. The tent will remain in place from April 10-13 until final repairs are completed.

Requester: Date of Request:

Supervising Tradesperson: Unit:

Trade Supervisor: Unit: Date:

Contractor: Phone #:

Coordinator/Project Manager: Phone #: Date:

Reviewed by Trade Supervisor(s)/Shop(s) Affected:

Name: Electrical Mechanical Shop		Date:	Name: Plumber Fitter Shop		Date:
Signature/Stamp:	APPROVED <i>By Steve Pepper (spepper@uwo.ca) at 1:17 pm, Apr 10, 2015</i>		Signature/Stamp:		
Name: WES		Date:	Principal Occupants:		
Signature/Stamp:	REVIEWED <i>By Wayne Drummond (ppdwad@uwo.ca) at 10:05 am, Apr 10, 2015</i>		Name:	Ext.:	Date:
Name:		Date:	Name:	Ext.:	Date:
Name:		Date:	Name:	Ext.:	Date:
Name:		Date:	Name:	Ext.:	Date:
Signature/Stamp:		Approval to Proceed: <input type="checkbox"/> Date: <input type="text"/>			
Signature/Stamp:		APPROVED <i>By Andrew (fmfinterr@uwo.ca) at 1:49 pm, Apr 10, 2015</i>			

Notes:



BASEMENT FLOOR

787.88 FT.

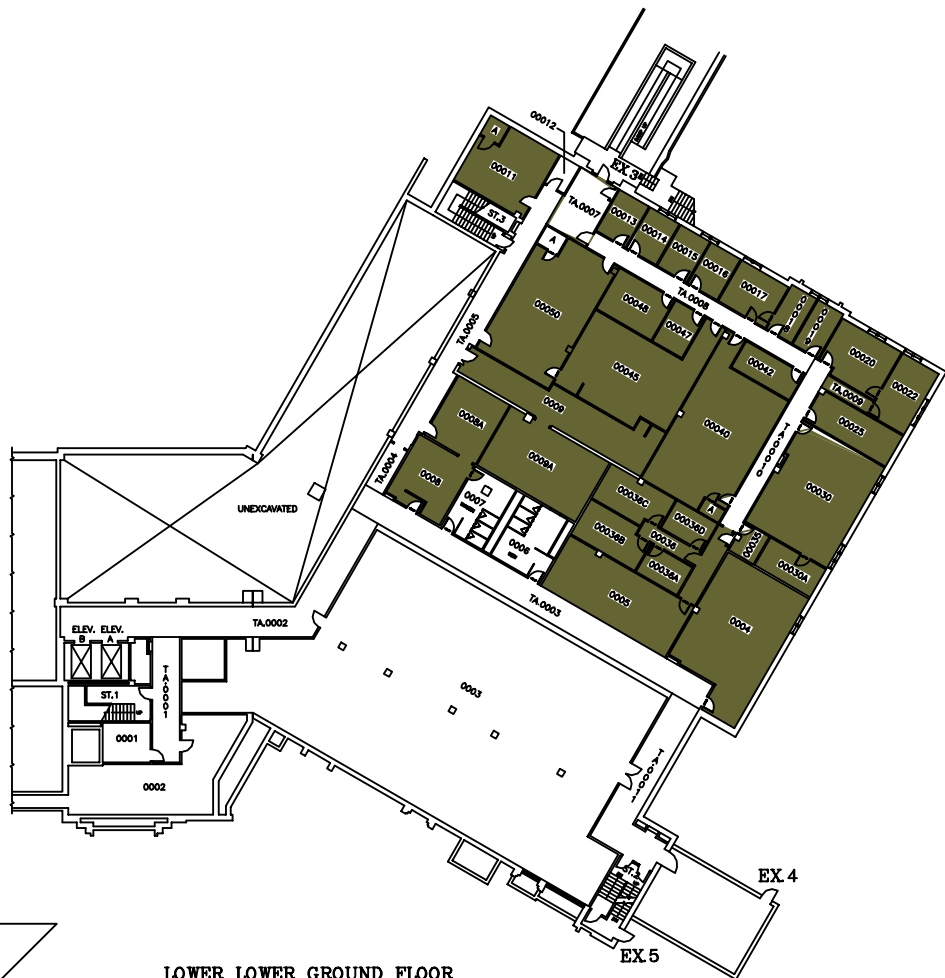

LOWER LOWER GROUND FLOOR

798.89 FT.

SYSTEM	ZONE #
113	A
114	B
	C

**THE UNIVERSITY of WESTERN ONTARIO
PHYSICAL PLANT DEPARTMENT**

	SCALE
	DATE 98-01-28
	DRAWN R. THOMAS
	CHECKED
	APPROVED

Facilities Engineering & Construction

	SCALE
MINIATURE FLOOR PLAN - LEVELS 01 & 02 (BASEMENT & LOWER LOWER GROUND FLOORS)	VARIES

DENTAL SCIENCES BLDG.

01

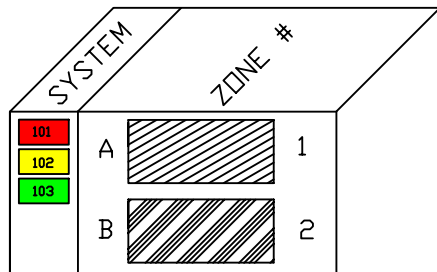

FAN 101, 102, 103, 104 & 113
NEED TO BE SHUTDOWN
WHEN WORK IN THE
CEILING IS REQUIRED
(SUPPLY & RETURN)

THE UNIVERSITY of WESTERN ONTARIO
PHYSICAL PLANT DEPARTMENT

	SCALE	88-09-11
	DATE	R. THOMAS
	CHECKED	
	APPROVED	

Facilities Engineering & Construction

SCALE	1" = 10' 1" 2" 3" 4" 5" 6" 8" 10"	812.80 FT.
MINIATURE FLOOR PLAN - LEVEL 03 (LOWER GROUND FLOOR)		02

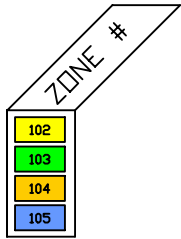

**THE UNIVERSITY of WESTERN ONTARIO
PHYSICAL PLANT DEPARTMENT**

	SCALE
	DATE 98-01-21
	DRAWN R. THOMAS
	CHECKED [Signature]
	APPROVED [Signature]
Facilities Engineering & Construction	DWG FILE No. DSB\MIN
SCALE 1" = 10' 10" 15" 20" 25" 30"	GEOMETRIC ELEV. 828.86 FT.
MINIATURE FLOOR PLAN - LEVEL 04 (GROUND FLOOR)	
DENTAL SCIENCES BLDG.	
03	

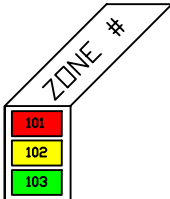

THE UNIVERSITY of WESTERN ONTARIO
PHYSICAL PLANT DEPARTMENT

SCALE	
DATE	98-08-08
DRAWN	R. THOMAS
CHECKED	
APPROVED	
DRAWN BY	DSB/AM
GEOMETRIC ELEV.	840.88 FT.
	04

Facilities Engineering & Construction

SCALE 0 5 10 15 20 25 30

MINIATURE FLOOR PLAN - LEVEL 05 (FIRST FLOOR)

DENTAL SCIENCES BLDG.



SYSTEM	ZONE #
101	F
102	G
103	H
	I

THE UNIVERSITY of WESTERN ONTARIO
PHYSICAL PLANT DEPARTMENT

		SCALE
		DATE 98-08-08
		DRAWN BY R. THOMAS
		CHECKED

Facilities Engineering & Construction

MINIATURE FLOOR PLAN - LEVEL 06
 (SECOND FLOOR)

DENTAL SCIENCES BLDG. 05

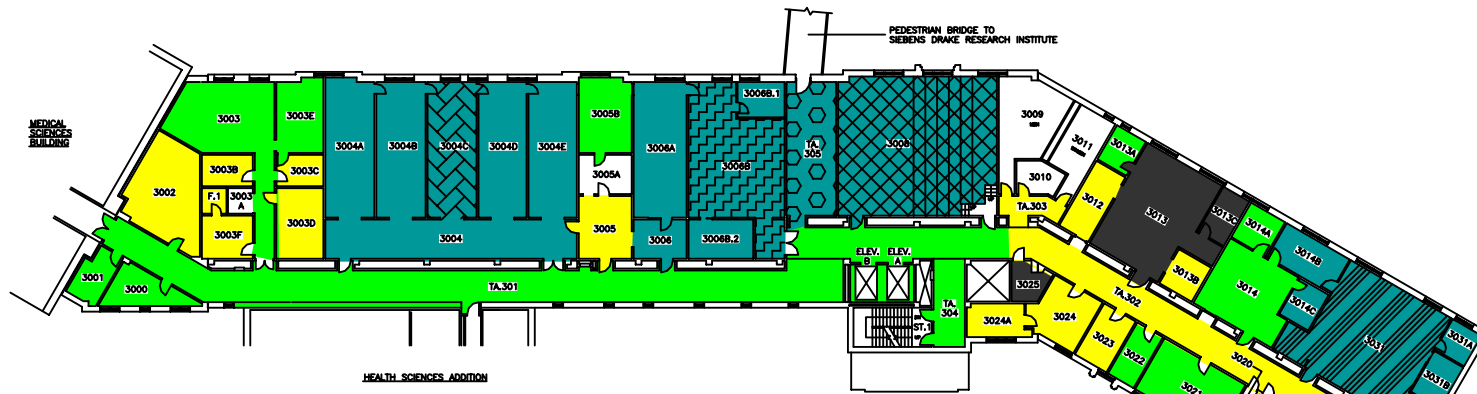

HEALTH SCIENCES ADDITION

THIRD FLOOR

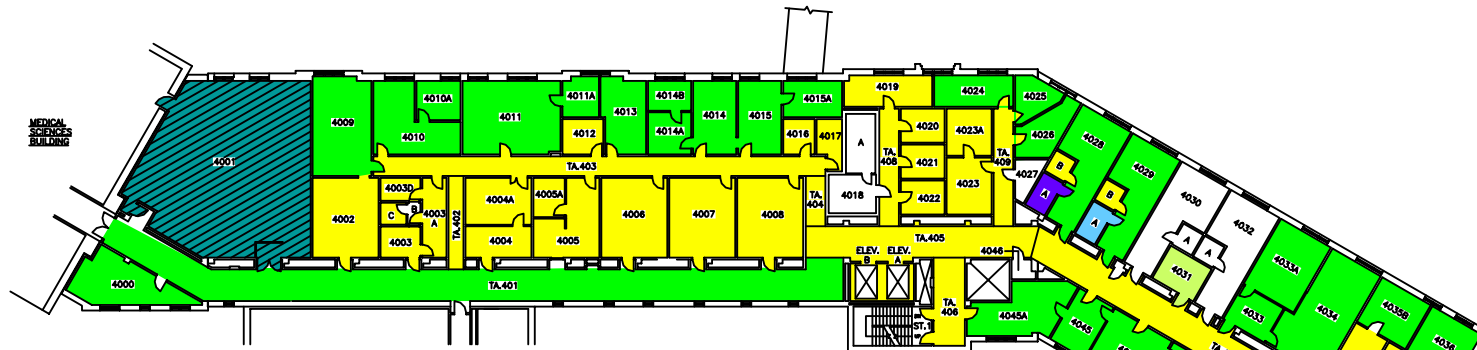

HEALTH SCIENCES ADDITION

FOURTH FLOOR

SYSTEM	ZONE #
102	A
103	B
107	C
108	D
109	E
110	F
111	

THE UNIVERSITY of WESTERN ONTARIO
PHYSICAL PLANT DEPARTMENT

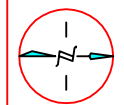

Facilities Engineering & Construction

MINIATURE FLOOR PLANS - LEVELS 07 & 08
(3RD AND 4TH FLOORS)

DENTAL SCIENCES BLDG.

SCALE
98-01-22
DATE
R. THOMAS
CHECKED
APPROVED
DWG FILE NO.
DSB/MIN
GEOMETRIC ELEV.
VARIES
SHEET
06

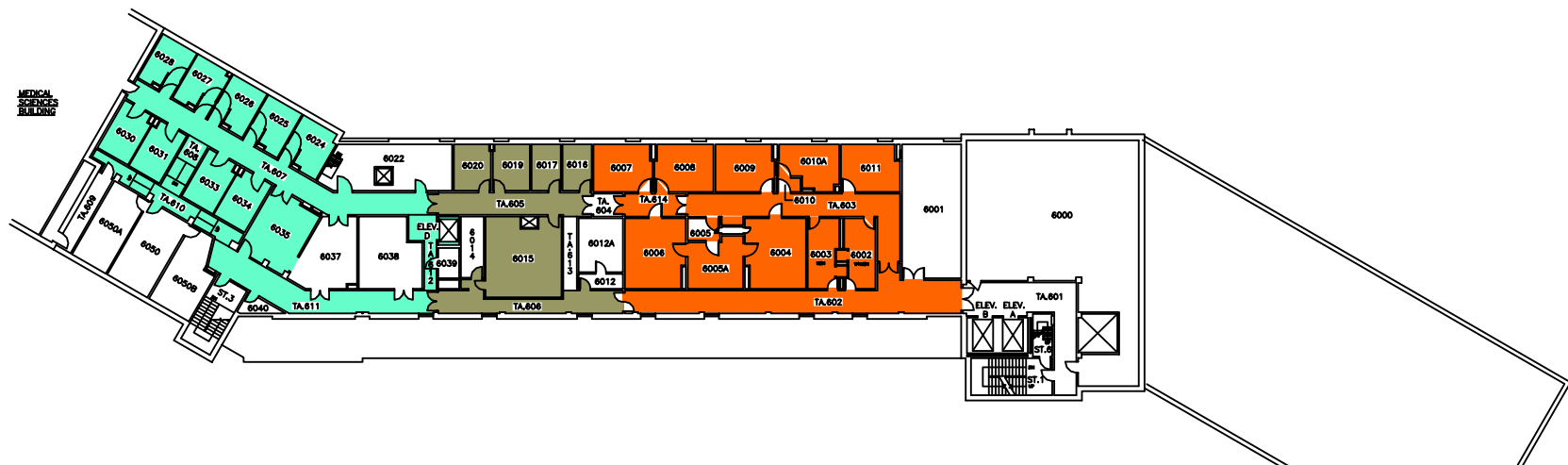

SIXTH FLOOR

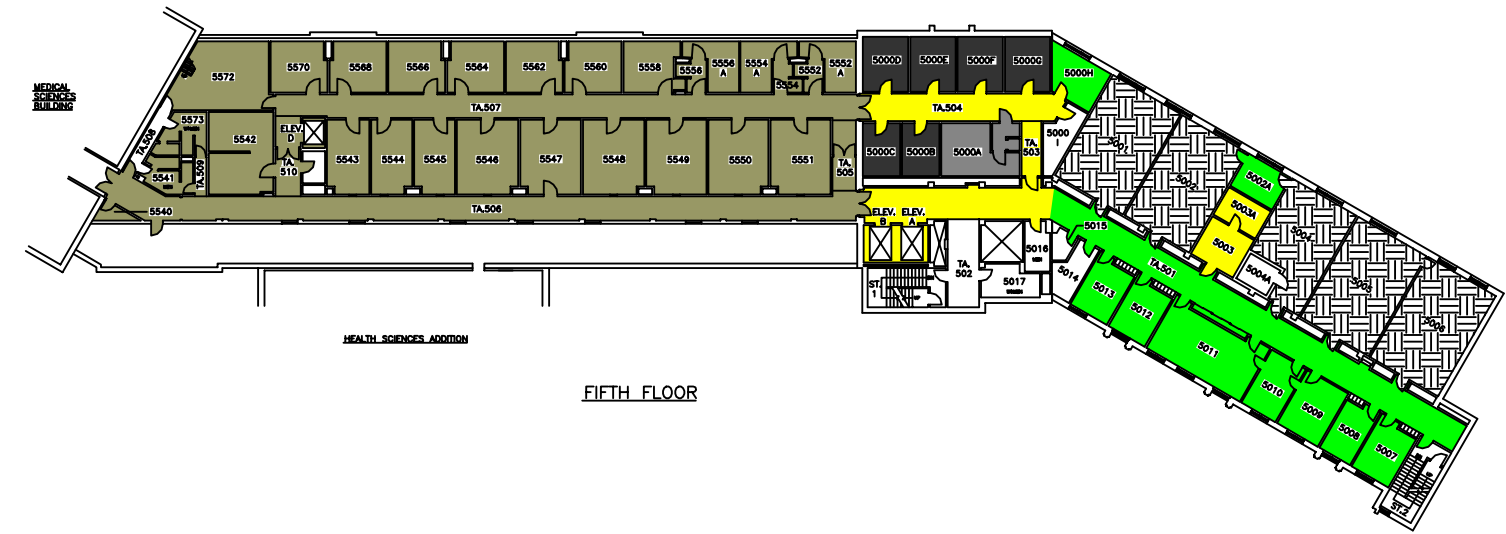

FIFTH FLOOR

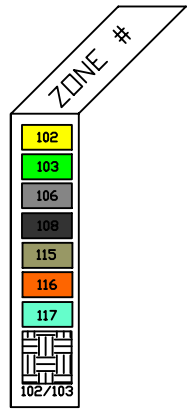

THE UNIVERSITY of WESTERN ONTARIO
PHYSICAL PLANT DEPARTMENT



<p>Facilities Engineering & Construction</p> <p>SCALE 0 5 10 15 20 25 30</p> <p>MINIATURE FLOOR PLANS - LEVELS 09 & 10 (5TH AND 6TH FLOORS)</p> <p>DENTAL SCIENCES BLDG.</p>		<p>SCALE</p> <p>DATE 98-01-21</p> <p>DESIGNED BY R. THOMAS</p> <p>CHECKED</p> <p>APPROVED</p> <p>DRAWN BY DSB/MIN</p> <p>GEOMETRIC BLVD VARIES</p> <p>07</p>
--	--	--

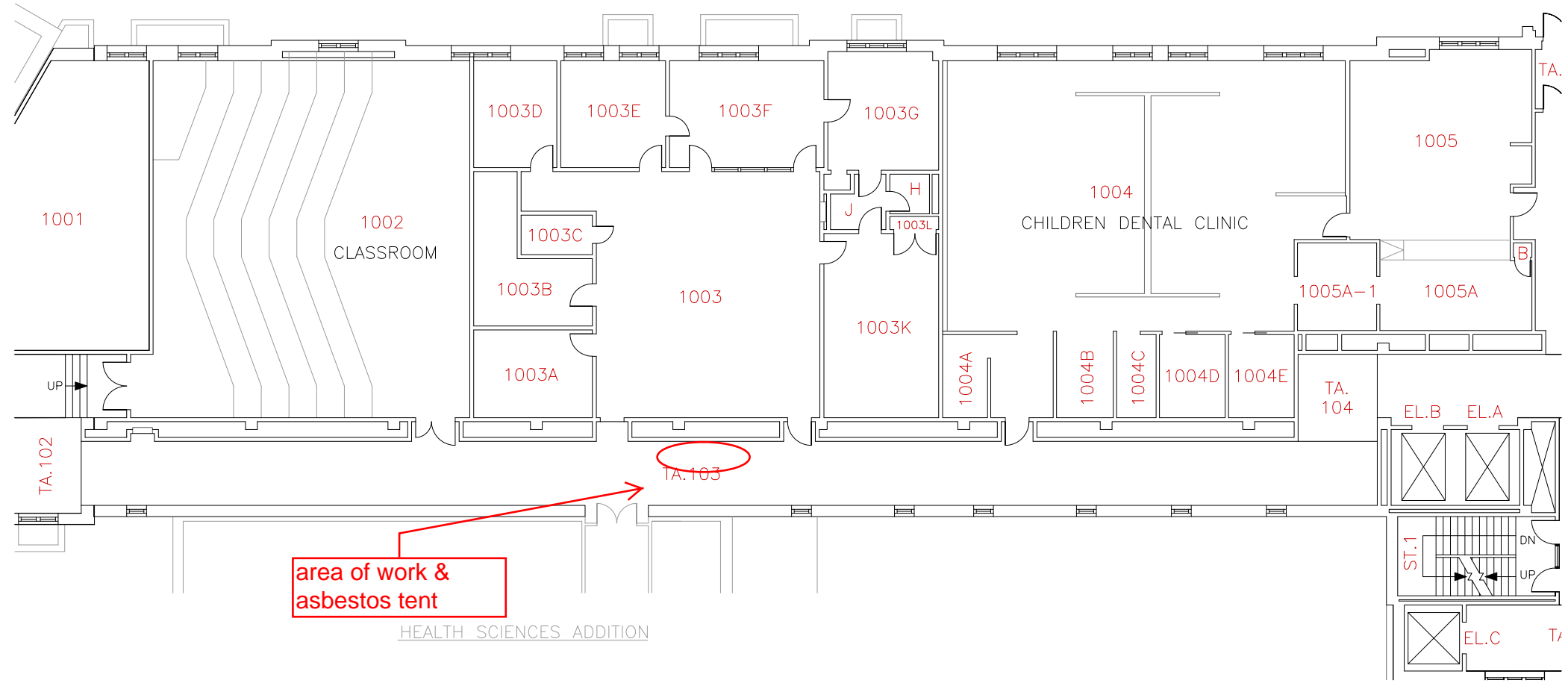

area of work & asbestos tent

HEALTH SCIENCES ADDITION