



Notice of Service Interruption/Area Closure
Western University
Facilities Management
Client Services 519-661-3304 (fmhelp@uwo.ca)

Submit by E-mail
 Print Form

Date of Interruption/Closure: Time(s):

Building(s) Affected: #1 #2
 #3 #4

Areas/Rooms Affected Alternate Route/Service:
 Work to be done in 0142Y-2 and TA.007, fans to be shut down.
 Areas served by Fan 101-104 & 113. See attached HVAC drawings.

Service to be interrupted: #1 #2
 #3 #4

Description/Reason for Project:
 Entry to ceiling space in 0142Y-2 and TA.007 for lighting upgrades.

Requester: Date of Request:

Supervising Tradesperson: Unit:

Trade Supervisor: Unit: Date:

Contractor: Phone #:

Coordinator/Project Manager: Phone #: Date:

Reviewed by Trade Supervisor(s)/Shop(s) Affected:

Name: <input type="text" value="Electrical / Mechanical Shop"/>	Date: <input type="text" value="Dec 3, 2015"/>	Name: <input type="text" value="WES Control"/>	Date: <input type="text" value="Dec 3, 2015"/>
---	--	--	--

Signature/Stamp: **APPROVED**
 By Steve Pepper (spepper@uwo.ca) at 10:47 am, Dec 03, 2015

Signature/Stamp: **REVIEWED**
 By Jesse Atkinson (jatin48@uwo.ca) at 1:05 pm, Dec 03, 2015

Name: Date:

Principal Occupants:

Signature/Stamp:

Name: <input type="text"/>	Ext. <input type="text"/>	Date: <input type="text"/>
----------------------------	---------------------------	----------------------------

Name: Date:

Name: <input type="text"/>	Ext. <input type="text"/>	Date: <input type="text"/>
----------------------------	---------------------------	----------------------------

Signature/Stamp:

Name: <input type="text"/>	Ext. <input type="text"/>	Date: <input type="text"/>
----------------------------	---------------------------	----------------------------

Name: Date:

Name: <input type="text"/>	Ext. <input type="text"/>	Date: <input type="text"/>
----------------------------	---------------------------	----------------------------

Signature/Stamp:

Approval to Proceed: Date:

APPROVED
 By Dan Trudgeon (fminterr@uwo.ca) at 7:23 am, Dec 04, 2015

Notes:



BASEMENT FLOOR

787.88 FT.

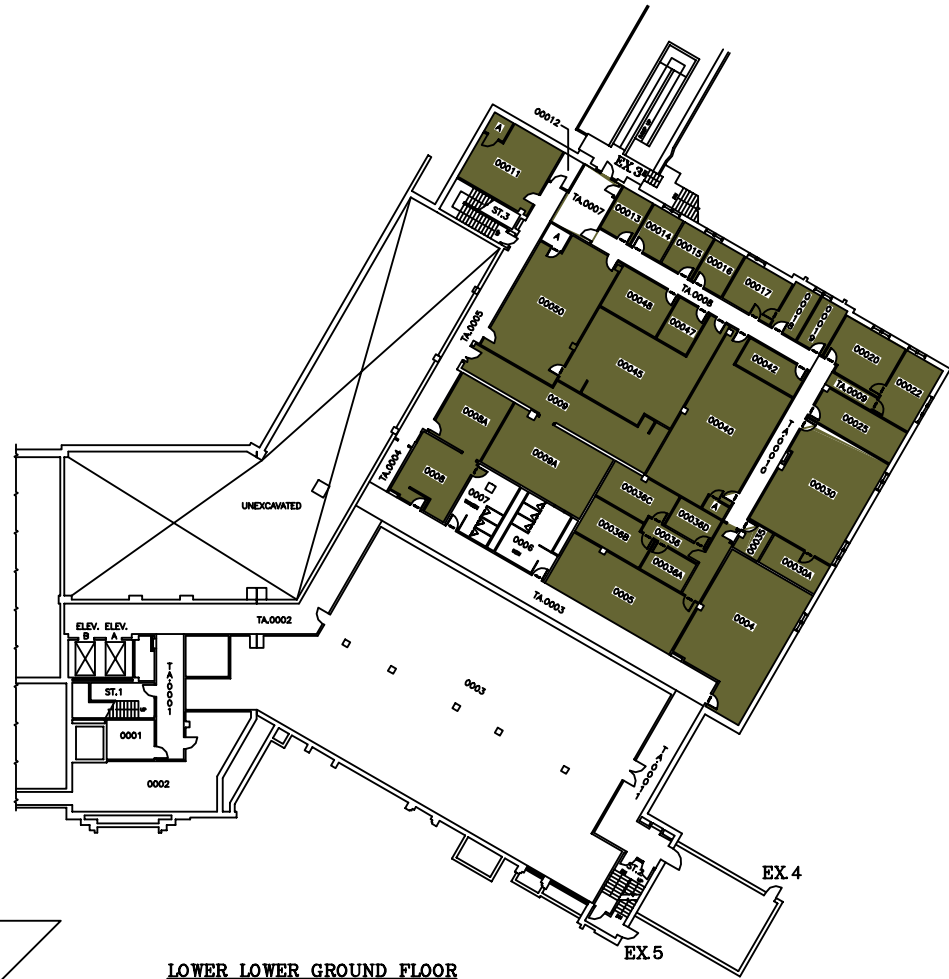

LOWER LOWER GROUND FLOOR

798.89 FT.

SYSTEM	ZONE #
113	A
114	B
	C

**THE UNIVERSITY of WESTERN ONTARIO
PHYSICAL PLANT DEPARTMENT**

	SCALE
	DATE 98-01-28
	DRAWN R. THOMAS
	CHECKED
	APPROVED

Facilities Engineering & Construction

SCALE 1" = 10' 0" (AS SHOWN)
MINIATURE FLOOR PLAN - LEVELS 01 & 02
(BASEMENT & LOWER LOWER GROUND FLOORS)

DENTAL SCIENCES BLDG. 01

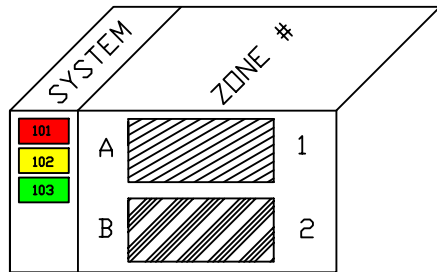

On behalf of amerucci

FAN 101, 102, 103, 104 & 113
NEED TO BE SHUTDOWN
WHEN WORK IN THE
CEILING IS REQUIRED

THE UNIVERSITY of WESTERN ONTARIO PHYSICAL PLANT DEPARTMENT	
	SCALE 98-09-11 DATE R. THOMAS CHECKED APPROVED
	Facilities Engineering & Construction SCALE 0 5 10 15 20 25 30 MINUTURE FLOOR PLAN - LEVEL 03 (LOWER GROUND FLOOR)
GEOMETRIC ELEV. 812.80 FT. 02	

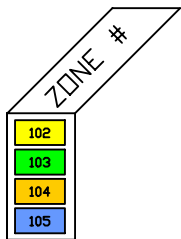
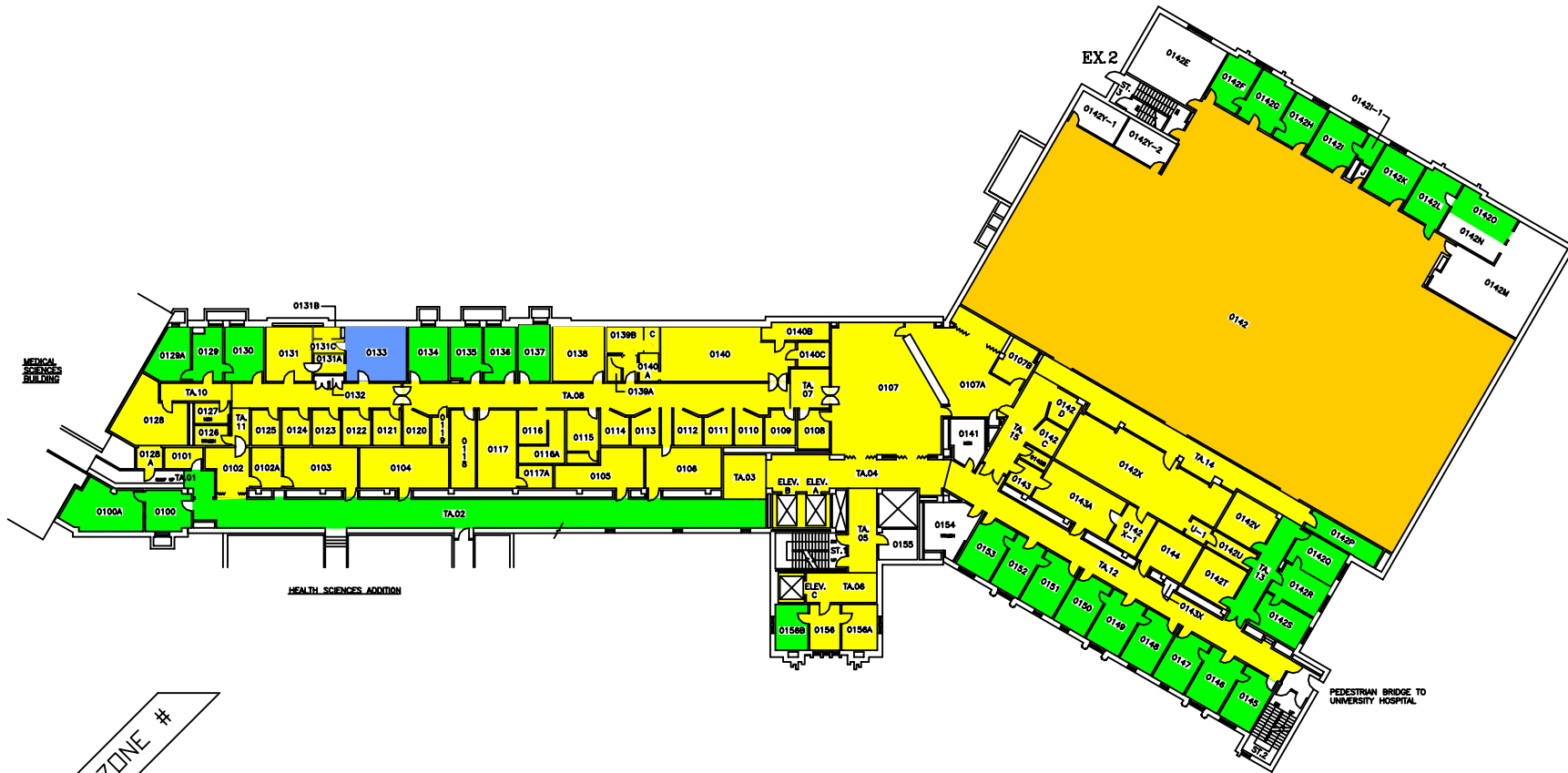

THE UNIVERSITY of WESTERN ONTARIO
PHYSICAL PLANT DEPARTMENT

	SCALE
	DATE 98-01-21
	DRAWN BY R. THOMAS
<p>Facilities Engineering & Construction</p> <p>SCALE 0 10 20 30 40 50</p> <p>MINIATURE FLOOR PLAN - LEVEL 04 (GROUND FLOOR)</p>	<p>CHECKED</p> <p>APPROVED</p> <p>DRAWN BY DSB/MIN</p> <p>GEOMETRIC ELEV. 828.86 FT.</p>
<p>DENTAL SCIENCES BLDG.</p> <p>03</p>	

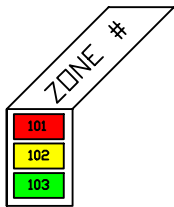

THE UNIVERSITY of WESTERN ONTARIO
PHYSICAL PLANT DEPARTMENT

SCALE
DATE 98-08-08
DRAWN R. THOMAS
CHECKED
APPROVED

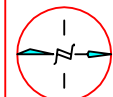

Facilities Engineering & Construction

SCALE 1" = 10' 1/8" 1/4" 1/2" 3/4" 1" 1 1/4" 1 1/2" 2" 3" 4" 5" 6" 8" 10" 12" 15" 20" 25" 30" 40" 50" 60" 80" 100'

MINIATURE FLOOR PLAN - LEVEL 05
(FIRST FLOOR)

DENTAL SCIENCES BLDG.

04



SYSTEM	ZONE #
101	F
102	G
103	H
	I

THE UNIVERSITY of WESTERN ONTARIO
PHYSICAL PLANT DEPARTMENT

	N
	SCALE
	DATE 98-08-08
	DRAWN BY R. THOMAS
	CHECKED

Facilities Engineering & Construction

SCALE	GRAPHIC ELEV.
1" = 10', 1/8" = 120'	854.88 FT.

MINIATURE FLOOR PLAN - LEVEL 06
(SECOND FLOOR)
DENTAL SCIENCES BLDG.

05

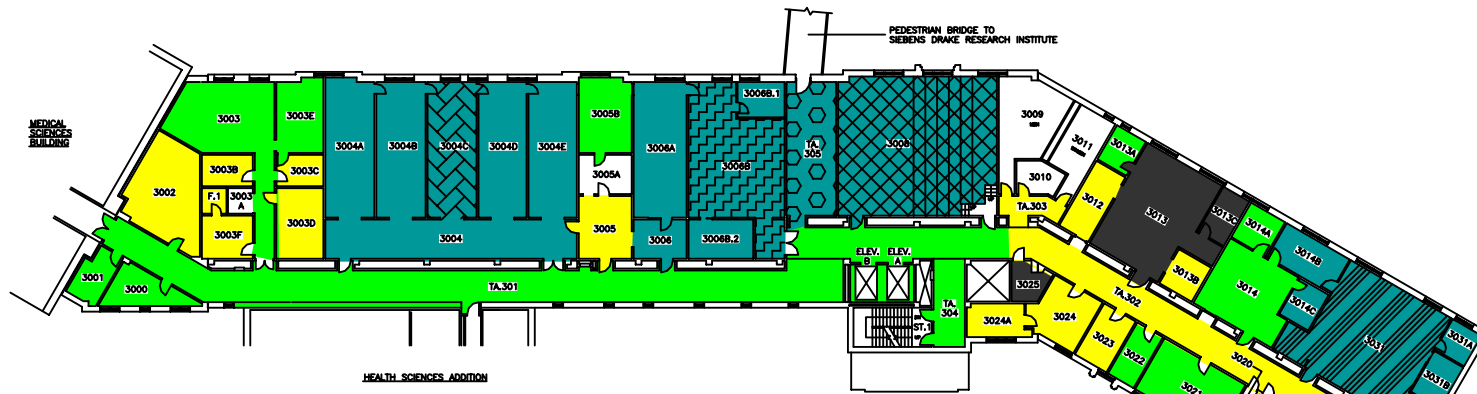

THIRD FLOOR

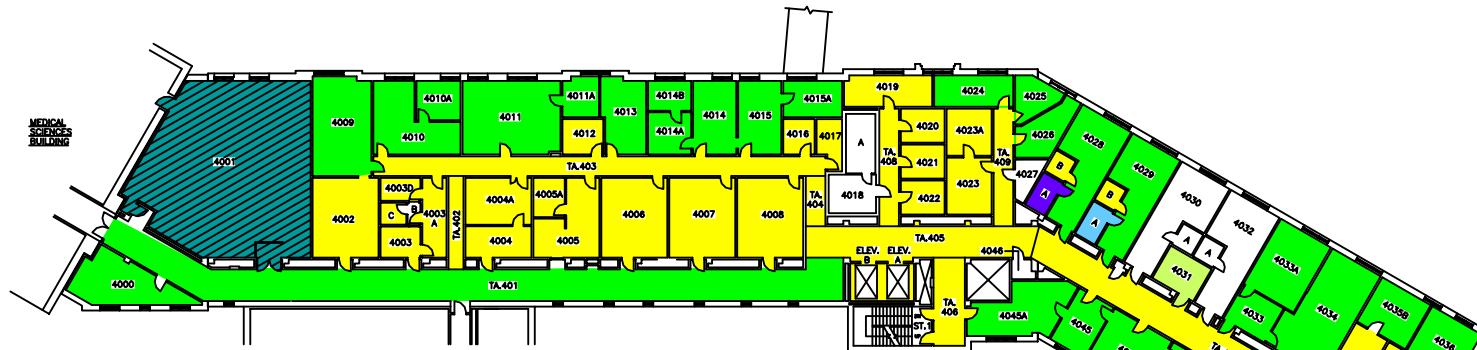

FOURTH FLOOR

SYSTEM	ZONE #
102	A
103	B
107	C
108	D
109	E
110	F
111	

THE UNIVERSITY of WESTERN ONTARIO
PHYSICAL PLANT DEPARTMENT

	SCALE
	DATE 98-01-22
	DESIGNED BY R. THOMAS
	CHECKED BY [Signature]

Facilities Engineering & Construction

SCALE	1:50	1:100	1:200	1:500	1:1000
MINIATURE FLOOR PLANS - LEVELS 07 & 08 (3RD AND 4TH FLOORS)	VARIES				

DENTAL SCIENCES BLDG. 06

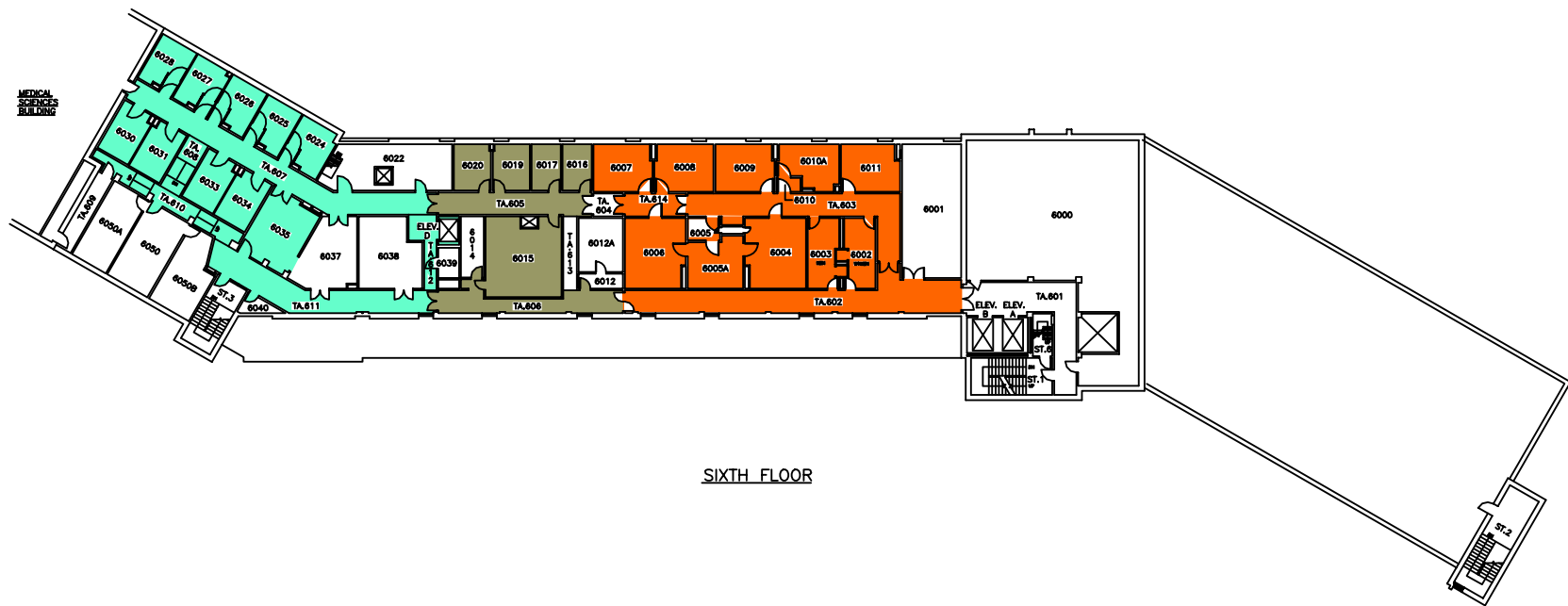

SIXTH FLOOR

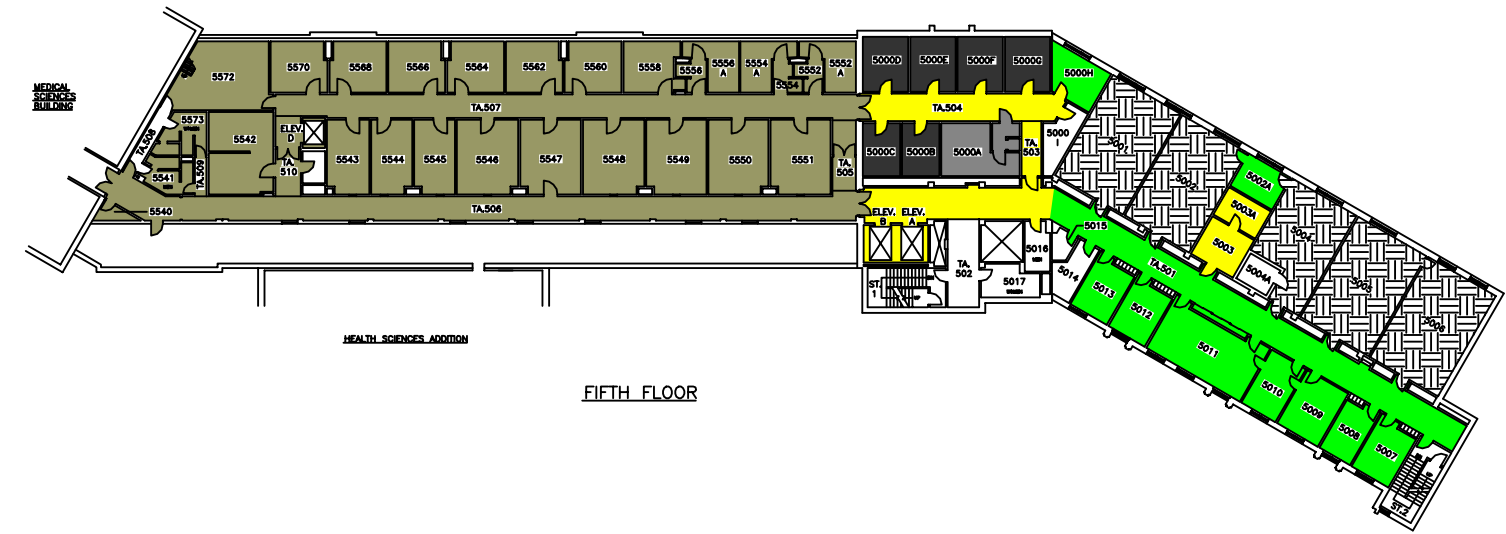

FIFTH FLOOR

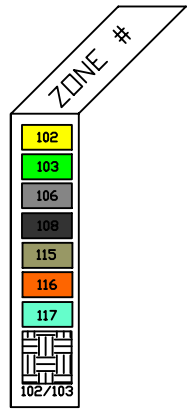

THE UNIVERSITY OF WESTERN ONTARIO PHYSICAL PLANT DEPARTMENT		
		SCALE: 1/8" = 1'-0"
		DATE: 98-01-21
		DESIGNED BY: R. THOMAS
CHECKED BY: [Blank]		
APPROVED BY: [Blank]		
DRAWN BY: DSB/MIN		
SCALE: 1/8" = 1'-0"		
MINIATURE FLOOR PLANS - LEVELS 09 & 10 (5TH AND 6TH FLOORS)		
DENTAL SCIENCES BLDG.		
07		