



Notice of Service Interruption/Area Closure
Western University
Facilities Management
Client Services 519-661-3304 (fmhelp@uwo.ca)

Submit by E-mail
 Print Form

Date of Interruption/Closure: Time(s):

Building(s) Affected: #1 #2
 #3 #4

Areas/Rooms Affected Alternate Route/Service:

Service to be interrupted: #1 #2
 #3 #4

Description/Reason for Project:

Requester: Date of Request:

Supervising Tradesperson: Unit:

Trade Supervisor: Unit: Date:

Contractor: Phone #:

Coordinator/Project Manager: Phone #: Date:

Reviewed by Trade Supervisor(s)/Shop(s) Affected:

Name: <input type="text" value="Electrical / Mechanical Shop"/>	Date: <input type="text" value="Dec 14, 2015"/>	Name: <input type="text" value="WES Control"/>	Date: <input type="text" value="Dec 14, 2015"/>
---	---	--	---

Signature/Stamp: **APPROVED**
 By Steve MacKay (smackay@uwo.ca) at 10:35 am, Dec 14, 2015

Signature/Stamp: **REVIEWED**
 By Jesse Atkinson (jatkin48@uwo.ca) at 3:29 pm, Dec 14, 2015

Principal Occupants:

Name:	Ext.	Date:

Approval to Proceed: Date:

Signature/Stamp: **APPROVED**
 By Dan Trudgeon (fminterr@uwo.ca) at 3:30 pm, Dec 14, 2015

Notes:



BASEMENT FLOOR

787.88 FT.

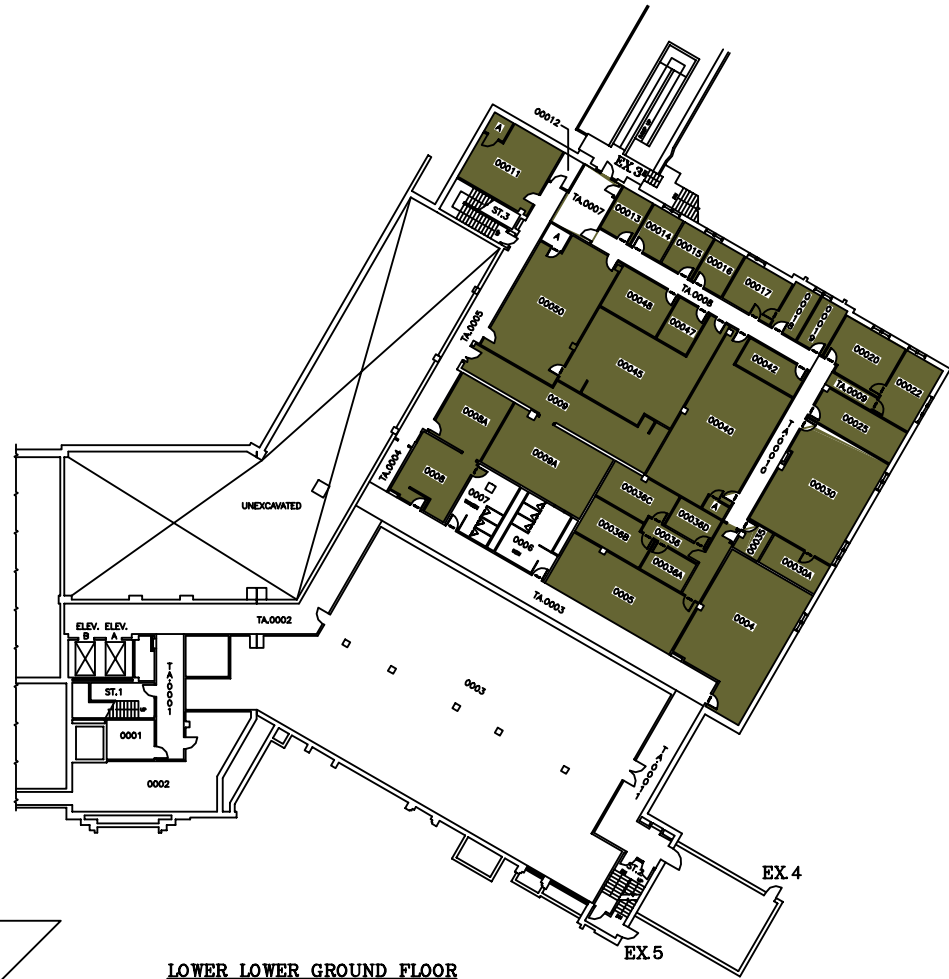

LOWER LOWER GROUND FLOOR

798.89 FT.

SYSTEM	ZONE #
113	A
114	B
	C

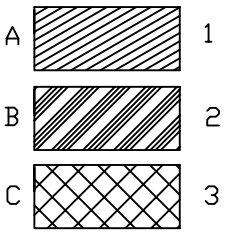

THE UNIVERSITY of WESTERN ONTARIO
PHYSICAL PLANT DEPARTMENT

	<p>SCALE</p> <p>DATE 98-01-28</p> <p>DRAWN R. THOMAS</p> <p>CHECKED</p> <p>APPROVED</p> <p>DESIGNED BY DSB/MIN</p> <p>ISSUED BY MIN</p> <p>SCALE</p> <p>MINIATURE FLOOR PLAN - LEVELS 01 & 02 (BASEMENT & LOWER LOWER GROUND FLOORS)</p> <p>DENTAL SCIENCES BLDG.</p>
--	---

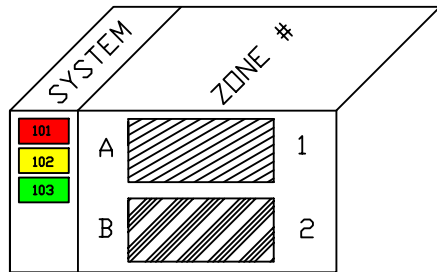

On behalf of amerucci

FAN 101, 102, 103, 104 & 113
NEED TO BE SHUTDOWN
WHEN WORK IN THE
CEILING IS REQUIRED

THE UNIVERSITY of WESTERN ONTARIO
PHYSICAL PLANT DEPARTMENT

	SCALE	812.80 FT.
	DATE	98-09-11
	DRAWN BY	R. THOMAS
	CHECKED BY	
Facilities Engineering & Construction		PROJECT NO.
MINIATURE FLOOR PLAN - LEVEL 03 (LOWER GROUND FLOOR)		02

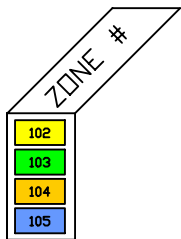

THE UNIVERSITY of WESTERN ONTARIO
PHYSICAL PLANT DEPARTMENT

	SCALE
	DATE 98-01-21
	DRAWN BY R. THOMAS
	CHECKED BY
	APPROVED BY
	DRAWN BY DSB/MIN
Facilities Engineering & Construction SCALE: 1" = 10'-0" (3048 mm) MINATURE FLOOR PLAN - LEVEL 04 (GROUND FLOOR)	
GEOMETRIC ELEV. 828.86 FT.	
DENTAL SCIENCES BLDG.	
03	

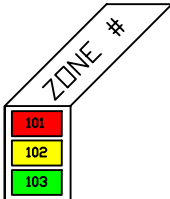

THE UNIVERSITY of WESTERN ONTARIO
PHYSICAL PLANT DEPARTMENT

	N	SCALE
		DATE
		98-09-08
		DRAWN BY
		R. THOMAS
	CHECKED	
	APPROVED	

Facilities Engineering & Construction

SCALE 0 5 10 15 20 25 30
MINIATURE FLOOR PLAN - LEVEL 05
(FIRST FLOOR)

DENTAL SCIENCES BLDG.

04



SYSTEM	ZONE #
101	F
102	G
103	H
	I

THE UNIVERSITY of WESTERN ONTARIO
PHYSICAL PLANT DEPARTMENT

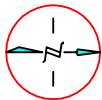

SCALE
DATE 98-09-08
DRAWN R. THOMAS
CHECKED
APPROVED

Facilities Engineering & Construction

SCALE 1" = 10' 1/8" 1/4" 1/2" 1" 2" 4" 8" 16" 30"	GRAPHIC ELEV. 854.88 FT.
--	-----------------------------

MINIATURE FLOOR PLAN - LEVEL 06 (SECOND FLOOR)
DENTAL SCIENCES BLDG. 05

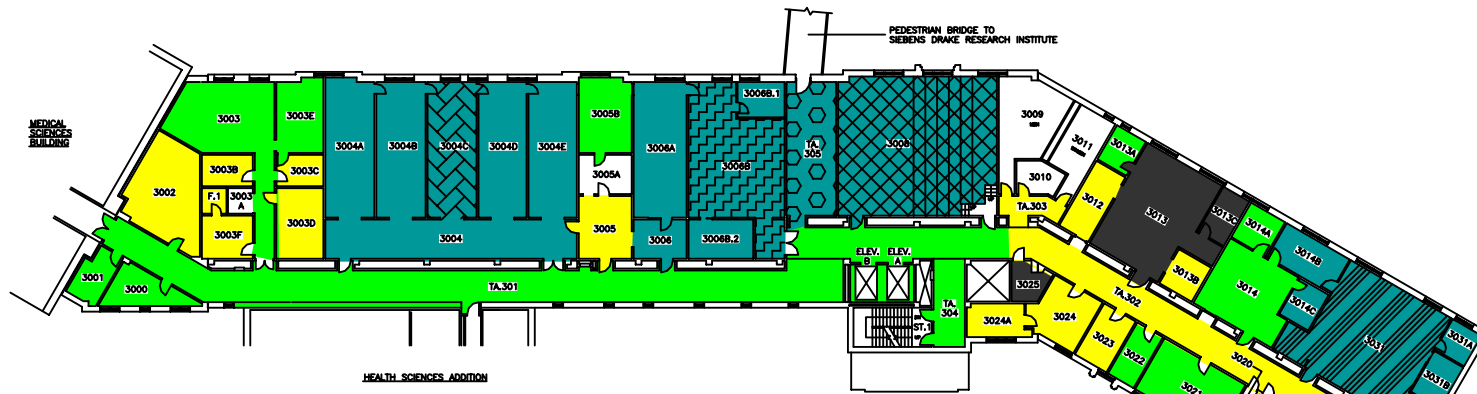

THIRD FLOOR

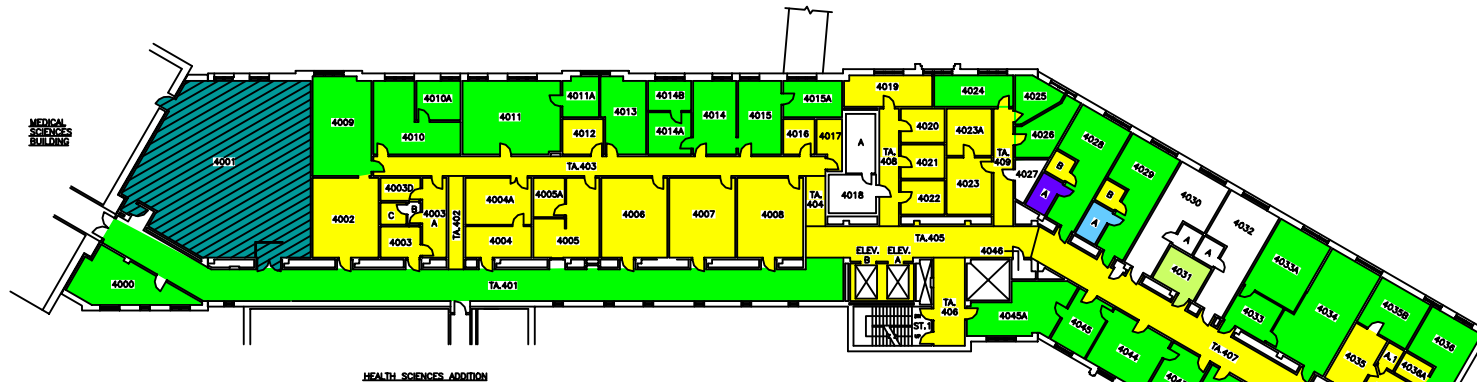

FOURTH FLOOR

SYSTEM	ZONE #
102	A
103	B
107	C
108	D
109	E
110	F
111	

THE UNIVERSITY of WESTERN ONTARIO
PHYSICAL PLANT DEPARTMENT

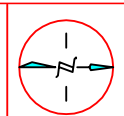

Facilities Engineering & Construction

MINIATURE FLOOR PLANS - LEVELS 07 & 08
(3RD AND 4TH FLOORS)

DENTAL SCIENCES BLDG.

SCALE	98-01-22
DATE	R. THOMAS
DESIGNED BY	APPROVED BY
DRAWN BY	DSB/MIN
GEOMETRIC ELEV.	VARIABLE
WEST	06

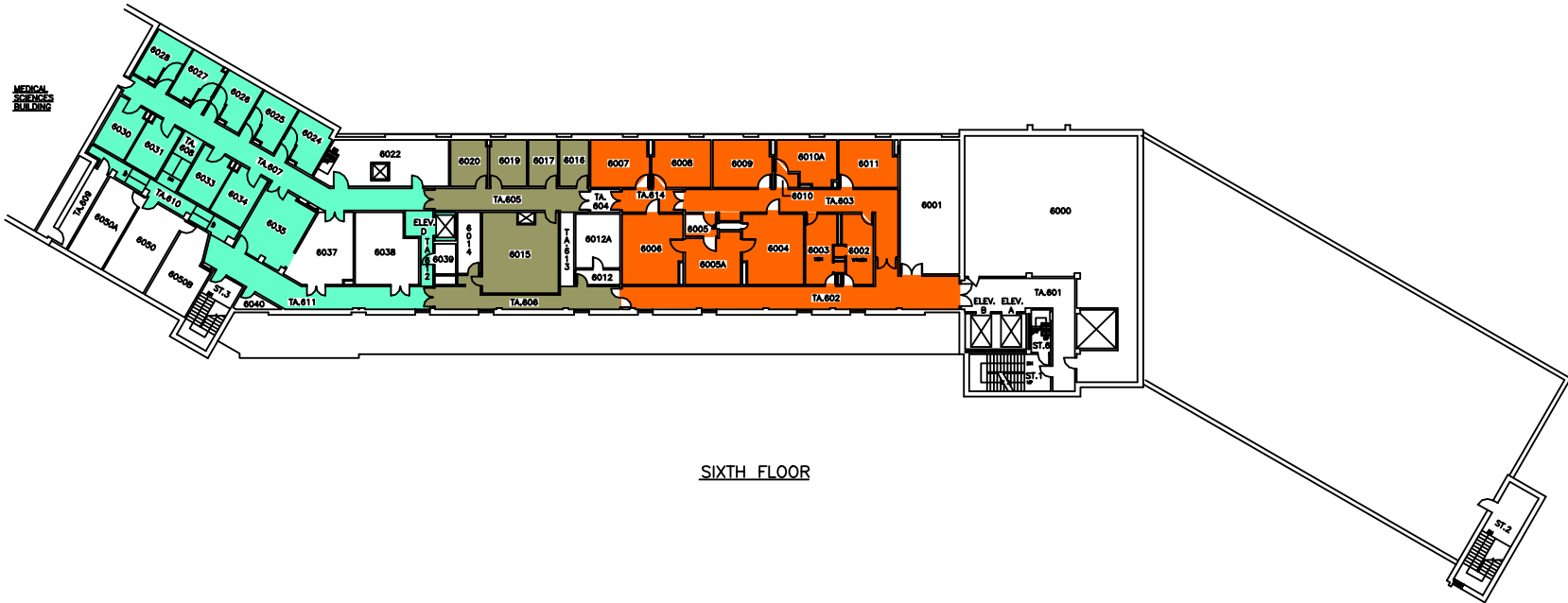

SIXTH FLOOR

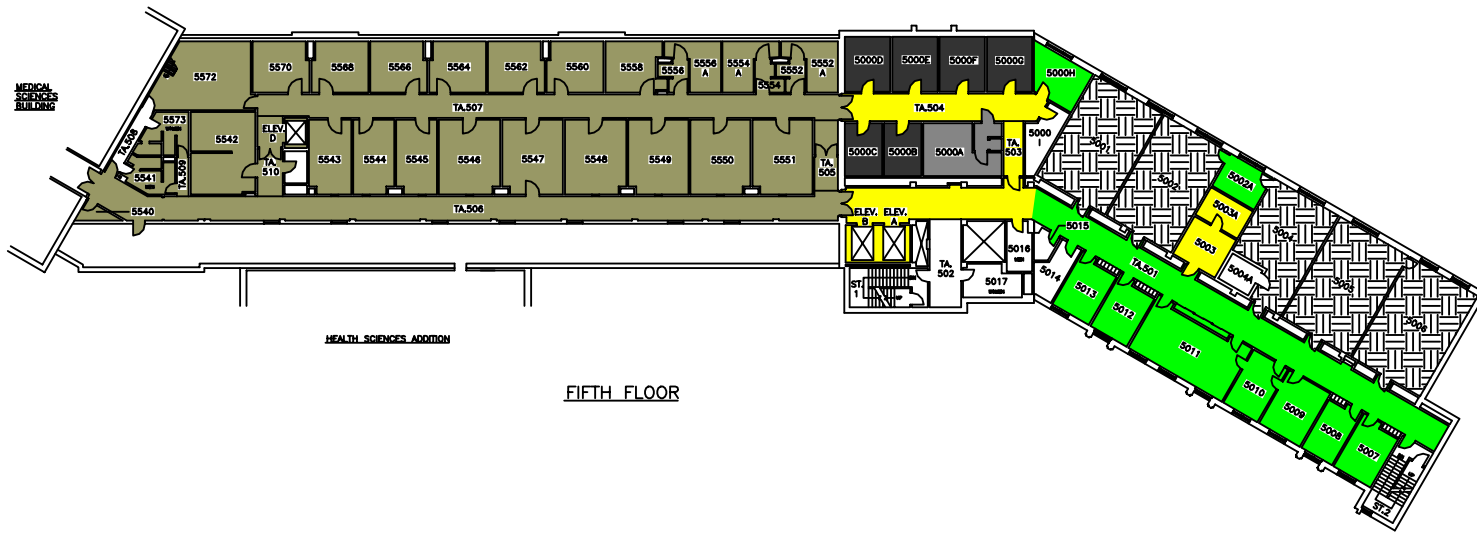

FIFTH FLOOR

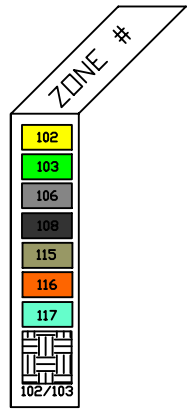

THE UNIVERSITY of WESTERN ONTARIO
PHYSICAL PLANT DEPARTMENT

Facilities Engineering & Construction

SCALE: 1" = 10' 0"

MINIATURE FLOOR PLANS - LEVELS 09 & 10 (5TH AND 6TH FLOORS)

DENTAL SCIENCES BLDG.

07