



Western  
UNIVERSITY - CANADA

Notice of Service Interruption/Area Closure  
Western University  
Facilities Management  
Client Services 519-661-3304 (fmhelp@uwo.ca)

Submit by E-mail  
Print Form

Date of Interruption/Closure: Dec 23, 2016  
Time(s): 7:30 am - 2:00 pm

Building(s) Affected: #1 Dental Science Building (DSB) #2 #3 #4

Areas/Rooms Affected Alternate Route/Service:  
Areas served by Fan system 101, 102, 103, 104 & 113. See attached HVAC drawings.

Service to be interrupted: #1 Supply Air Fan #2 Return Air Fan #3 #4

Description/Reason for Project:  
Preparation for abatement work in the DSB 4007 area.

Requester: SEM Construction Date of Request: Dec 20, 2016

Supervising Tradesperson: Unit:

Trade Manager: Unit: Date:

Contractor: SEM Construction ( Larry Northover ) Phone # +1 (519) 691-7593

Coordinator/Project Manager: Boris Pertout Phone # +1 (519) 521-2551 Date: Dec 20, 2016

Reviewed by Trade Manager(s)/Shop(s) Affected:  
Name: Electrical / Mechanical Shop Date: Dec 20, 2016 Name: WES Control Date: Dec 20, 2016

Signature/Stamp: [Handwritten Signature]

Signature/Stamp: RECEIVED  
By Wayne Drummond (ppdwad@uwo.ca) at 2:46 pm, Dec 20, 2016

Name: Date:

Principal Occupants:

Signature/Stamp:

Name: Ext. Date:

Name: Date:

Name: Ext. Date:

Signature/Stamp:

Name: Ext. Date:

Name: Date:

Name: Ext. Date:

Signature/Stamp:

Approval to Proceed: APPROVED  
By Dan Trudgeon (dtrudgeon@uwo.ca) at 9:41 am, Dec 22, 2016

Notes: Motor shop work order 594884.





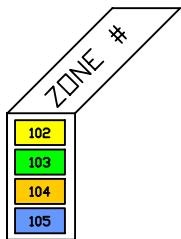
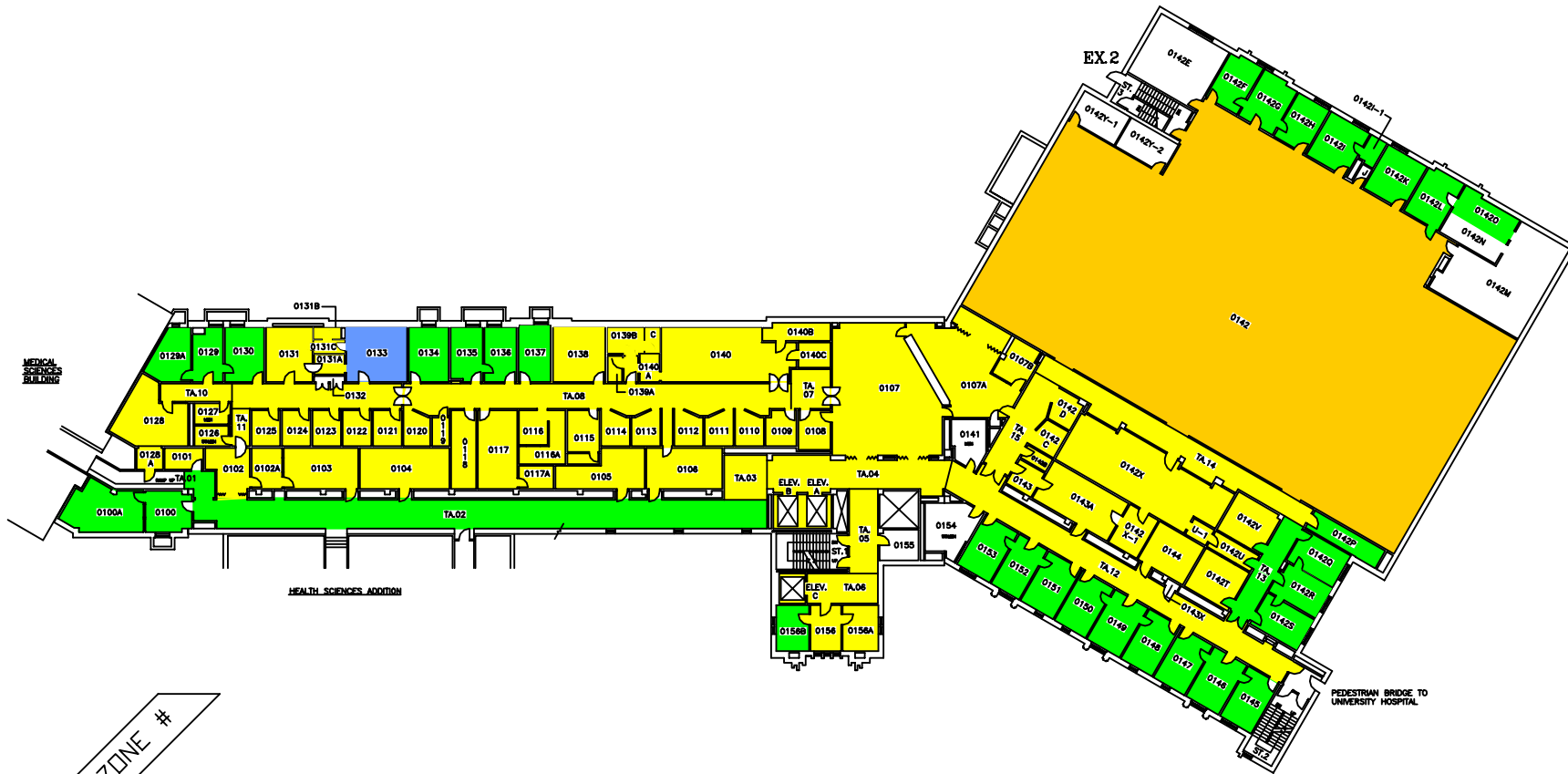

**THE UNIVERSITY of WESTERN ONTARIO**  
**PHYSICAL PLANT DEPARTMENT**

	SCALE
	DATE 98-01-21
	DRAWN BY R. THOMAS
	CHECKED BY [Signature]
Facilities Engineering & Construction	
SCALE 1" = 10' 1/8" 1/2" 1" 2" 3" 4" 5" 6" 8" 10" 12" 15" 20" 25" 30"	GEOMETRIC ELEV. 828.86 FT.
MINIATURE FLOOR PLAN - LEVEL 04 (GROUND FLOOR)	
<b>DENTAL SCIENCES BLDG.</b>	
<b>03</b>	

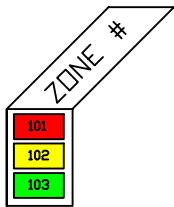

THE UNIVERSITY of WESTERN ONTARIO  
PHYSICAL PLANT DEPARTMENT

SCALE
DATE 98-08-08
DRAWN R. THOMAS
CHECKED
APPROVED

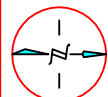

Facilities Engineering & Construction

SCALE 1" = 10' 1/8" 1/4" 1/2" 3/4" 1" 1 1/4" 1 1/2" 2" 3" 4" 6" 8" 10" 12" 15" 20" 24" 30" 36" 48" 60" 840.86 FT.

MINIATURE FLOOR PLAN - LEVEL 05  
(FIRST FLOOR)  
DENTAL SCIENCES BLDG.

04



SYSTEM	ZONE #
101	F
102	G
103	H
	I

THE UNIVERSITY of WESTERN ONTARIO  
PHYSICAL PLANT DEPARTMENT

	N
	SCALE
	DATE
	DESIGNED BY
	CHECKED BY

Facilities Engineering & Construction

MINIATURE FLOOR PLAN - LEVEL 06  
(SECOND FLOOR)

DENTAL SCIENCES BLDG.

05

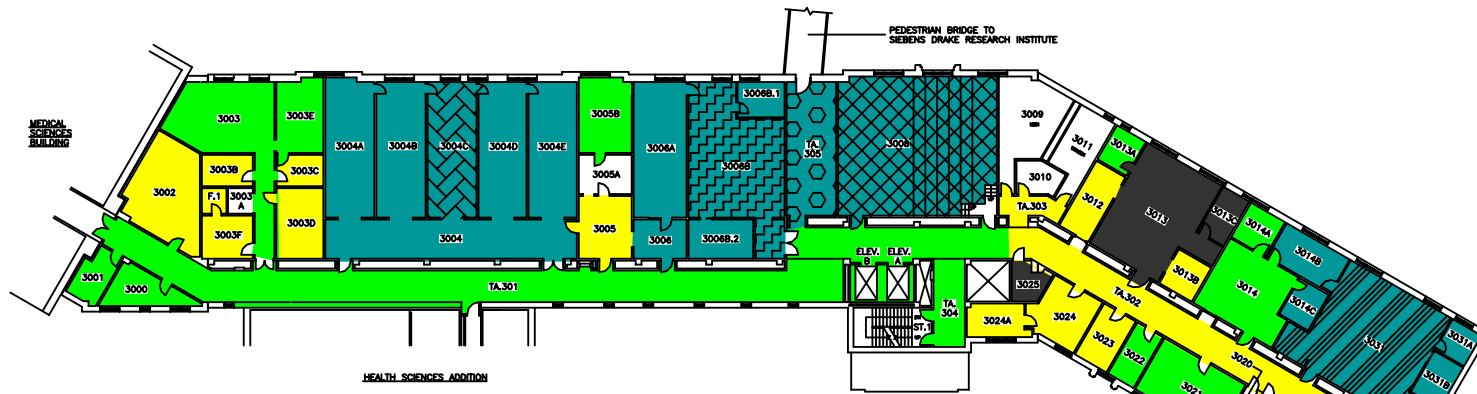

THIRD FLOOR

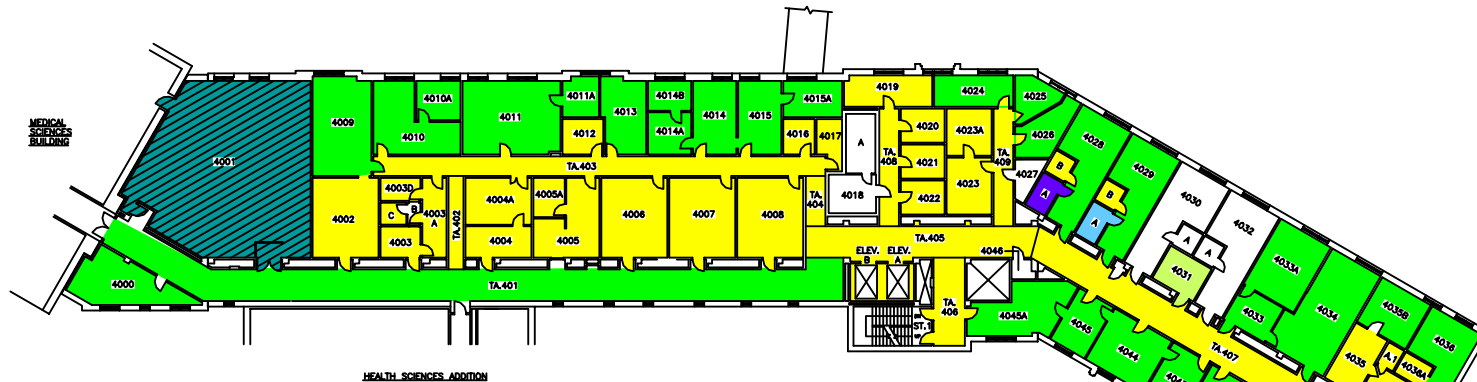

FOURTH FLOOR

SYSTEM	ZONE #
102	A
103	B
107	C
108	D
109	E
110	F
111	

THE UNIVERSITY of WESTERN ONTARIO  
PHYSICAL PLANT DEPARTMENT

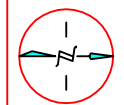

Facilities Engineering & Construction

SCALE: 1" = 10' 0" (3000 mm)  
MINIATURE FLOOR PLANS - LEVELS 07 & 08  
(3RD AND 4TH FLOORS)

DENTAL SCIENCES BLDG.

SCALE	SCALE
98-01-22	SCALE
R. THOMAS	SCALE
DESIGNED	SCALE
APPROVED	SCALE
DRAWN	SCALE
CHECKED	SCALE
DATE	SCALE
06	SCALE

