



Notice of Service Interruption/Area Closure
Western University
Facilities Management
Client Services 519-661-3304 (fmhelp@uwo.ca)

Submit by E-mail
 Print Form

Date of Interruption/Closure: Time(s):

Building(s) Affected: #1 #2
 #3 #4
 Areas/Rooms Affected Alternate Route/Service:

Service to be interrupted: #1 #2
 #3 #4
 Description/Reason for Project:

Requester: Date of Request:

Supervising Tradesperson: Unit:
 Trade Manager: Unit: Date:

Contractor: Phone #:
 Coordinator/Project Manager: Phone #: Date:

Reviewed by Trade Manager(s)/Shop(s) Affected:

Name: Electrical / Mechanical Shop	Date: Aug 29, 2017	Name: WES Control	Date: Aug 29, 2017
Signature/Stamp: APPROVED <i>By spepper (spepper@uwo.ca) at 11:29 am, Aug 29, 2017</i>		Signature/Stamp: REVIEWED <i>By Jesse Atkinson (jatin48@uwo.ca) at 2:42 pm, Aug 29, 2017</i>	

Name: Date:

Principal Occupants:

Name:	Ext.:	Date:
Name:	Ext.:	Date:
Name:	Ext.:	Date:
Name:	Ext.:	Date:

Approval to Proceed: Date:

Signature/Stamp: **APPROVED**
By Dan Trudgeon (dtrudgeo@uwo.ca) at 3:19 pm, Aug 29, 2017

Notes:



BASEMENT FLOOR

787.88 FT.

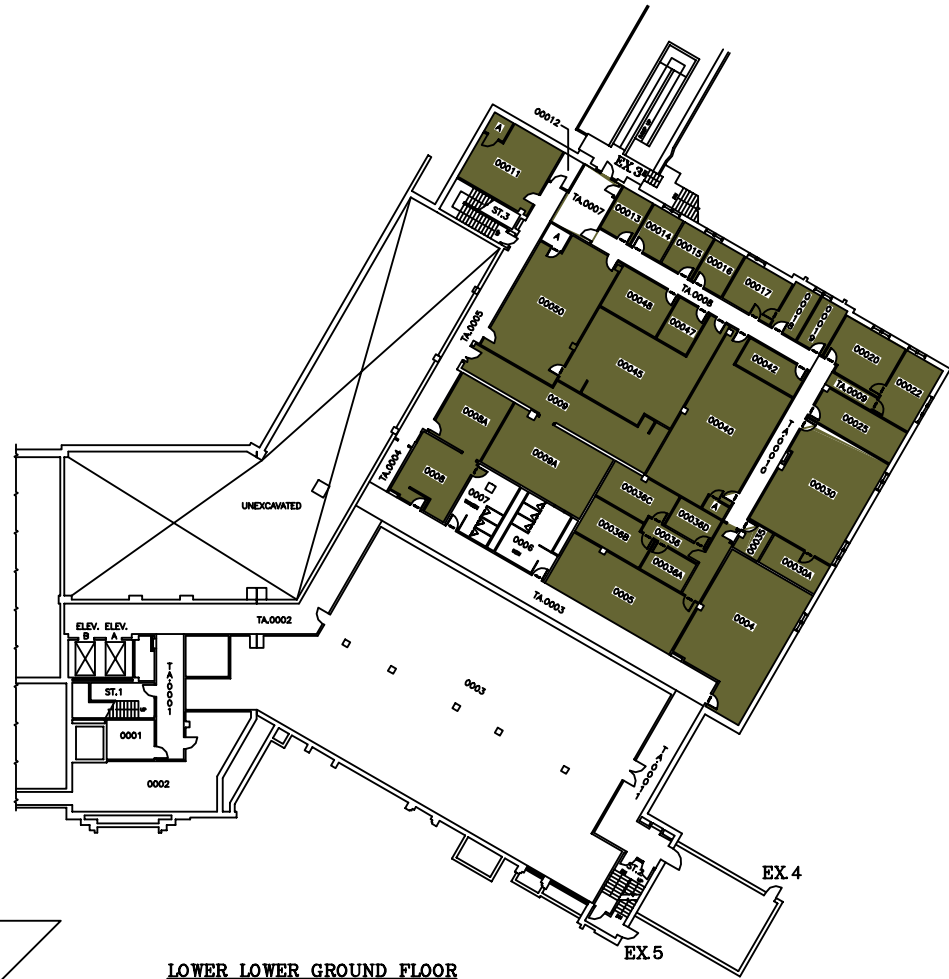

LOWER LOWER GROUND FLOOR

798.89 FT.

SYSTEM	ZONE #
113	A
114	B
	C

THE UNIVERSITY of WESTERN ONTARIO
PHYSICAL PLANT DEPARTMENT

SCALE: VARIES
 DATE: W9-01-28
 DRAWN BY: R. THOMAS
 CHECKED BY: []
 APPROVED BY: []
 SHEET NO.: DSB/MIN
 QUANTITY: VARIES

Facilities Engineering & Construction

SCALE: 1" = 10'-0" (BASEMENT & LOWER LOWER GROUND FLOORS)

MINIATURE FLOOR PLAN - LEVELS 01 & 02 (BASEMENT & LOWER LOWER GROUND FLOORS)

DENTAL SCIENCES BLDG.

SCALE: VARIES
 DATE: W9-01-28
 DRAWN BY: R. THOMAS
 CHECKED BY: []
 APPROVED BY: []
 SHEET NO.: DSB/MIN
 QUANTITY: VARIES

01

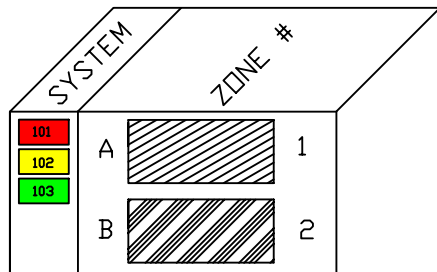

On behalf of amerucci

**FAN 101, 102, 103, 104 & 113
NEED TO BE SHUTDOWN
WHEN WORK IN THE
CEILING IS REQUIRED
(SUPPLY & RETURN)**

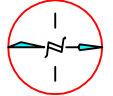
THE UNIVERSITY of WESTERN ONTARIO PHYSICAL PLANT DEPARTMENT	
	SCALE
	DATE 98-09-11
	DRAWN BY R. THOMAS
	CHECKED APPROVED
Facilities Engineering & Construction	
SCALE 1" = 10' 1" 5' 1" 2" 1" 1/2" 1" 1/4" 1/2" 1/8" 1/16"	GRAPHIC ELEV. 812.80 FT.
MINIATURE FLOOR PLAN - LEVEL 03 (LOWER GROUND FLOOR)	
DENTAL SCIENCES BLDG.	
	02

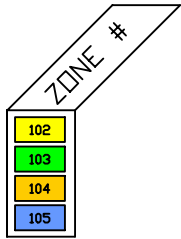
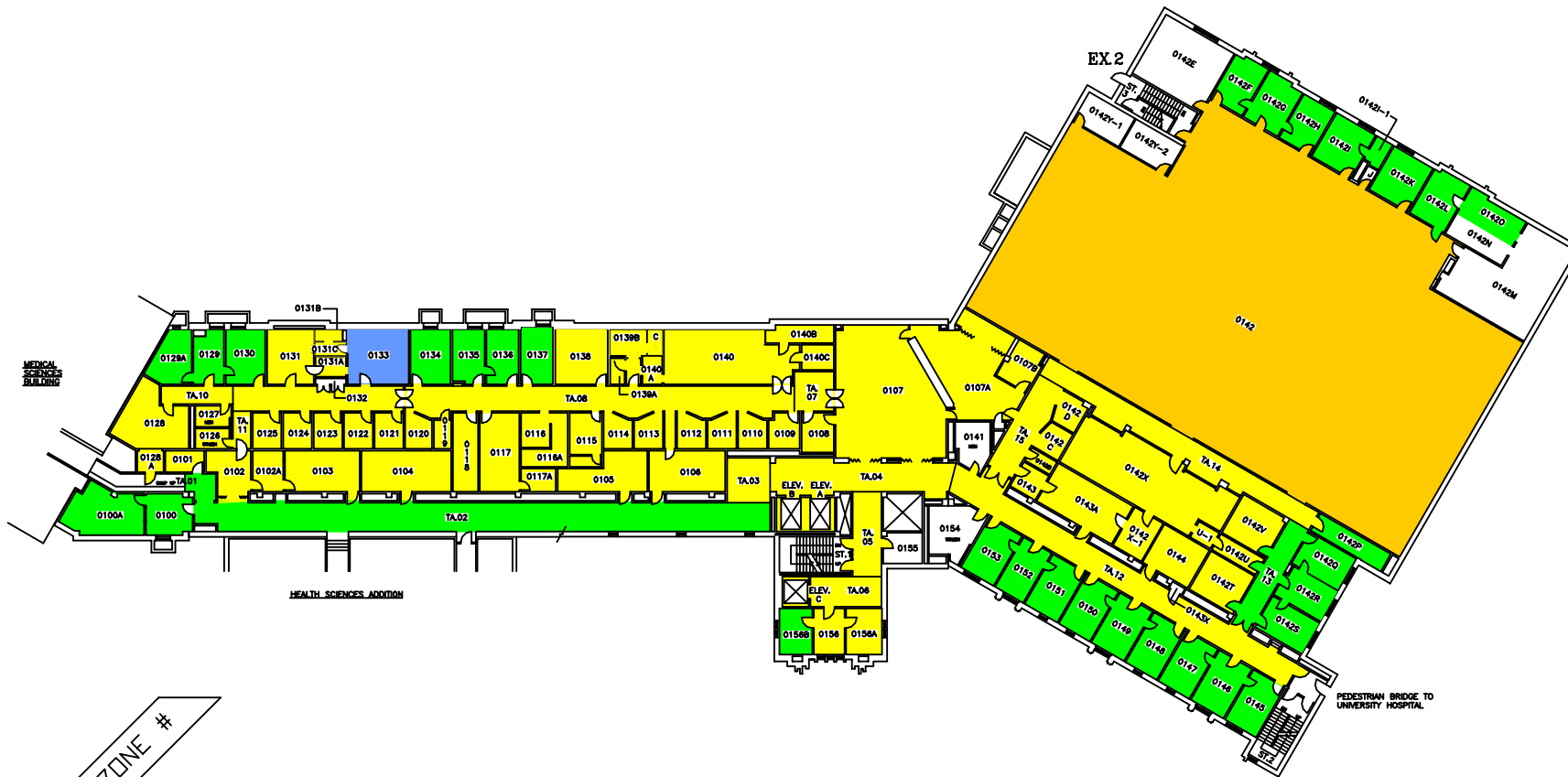

THE UNIVERSITY of WESTERN ONTARIO
PHYSICAL PLANT DEPARTMENT

SCALE
 98-01-21
 DRAWN BY
 R. THOMAS
 CHECKED
 APPROVED
 SHEET NO.
 DSB/MIN
 GEOMETRIC ELEV.
 828.88 FT.

Facilities Engineering & Construction

SCALE 0 5 10 15 20 25 30
 MINATURE FLOOR PLAN - LEVEL 04
 (GROUND FLOOR)

DENTAL SCIENCES BLDG.

03

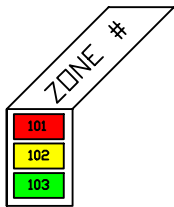

THE UNIVERSITY of WESTERN ONTARIO
PHYSICAL PLANT DEPARTMENT

SCALE
DATE 98-08-08
DRAWN R. THOMAS
CHECKED
APPROVED

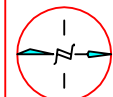

Facilities Engineering & Construction

SCALE 1" = 10' 1/8" 1/4" 1/2" 3/4" 1" 1 1/4" 1 1/2" 2" 3" 4" 6" 8" 10" 12" 15" 20" 24" 30" 36" 48" 60" 840.88 FT.

MINIATURE FLOOR PLAN - LEVEL 05
(FIRST FLOOR)

DENTAL SCIENCES BLDG.

04

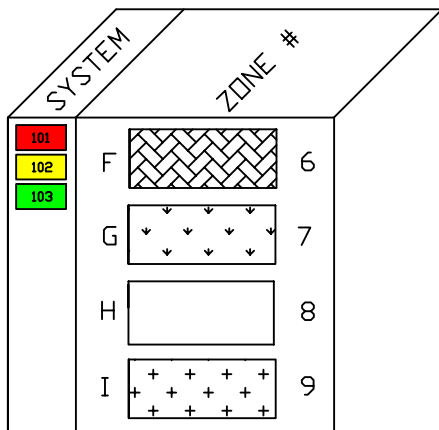

THE UNIVERSITY of WESTERN ONTARIO		PHYSICAL PLANT DEPARTMENT	
	SCALE	DATE	98-08-08
	DESIGNED BY	ENGINEER	R. THOMAS
	CHECKED	APPROVED	
	DRAWN BY	DATE	DSB/MIN
Facilities Engineering & Construction		GRAPHIC ELEV. 854.88 FT.	
SCALE: 1/8" = 1'-0"		MINIATURE FLOOR PLAN - LEVEL 06 (SECOND FLOOR)	
DENTAL SCIENCES BLDG.			05

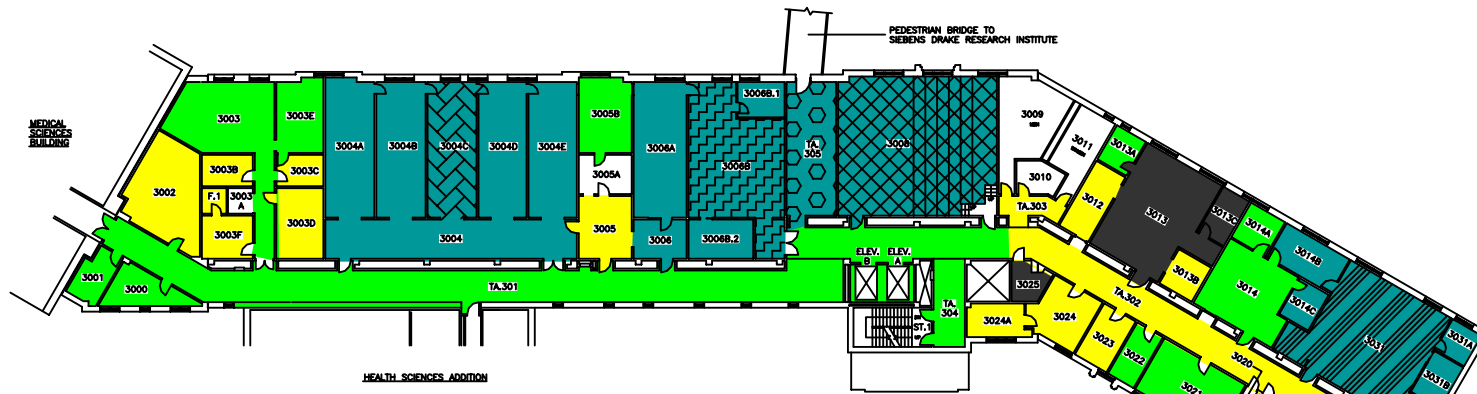

HEALTH SCIENCES ADDITION

THIRD FLOOR

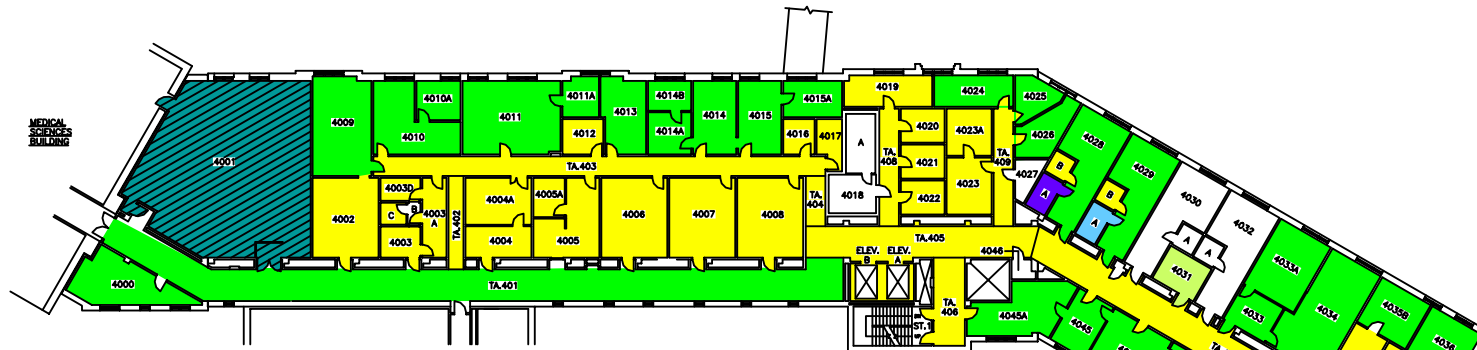

HEALTH SCIENCES ADDITION

FOURTH FLOOR

SYSTEM	ZONE #
102	A
103	B
107	C
108	D
109	E
110	F
111	

THE UNIVERSITY of WESTERN ONTARIO
PHYSICAL PLANT DEPARTMENT

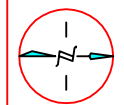

Facilities Engineering & Construction

MINIATURE FLOOR PLANS - LEVELS 07 & 08
(3RD AND 4TH FLOORS)

DENTAL SCIENCES BLDG.

SCALE
98-01-22
DATE
R. THOMAS
CHECKED
APPROVED
DWG FILE NO.
DSB/MIN
GEOMETRIC ELEV.
VARIES
SHEET
06

