



**Notice of Service Interruption/Area Closure**  
**Western University**  
**Facilities Management**  
**Client Services 519-661-3304 (fmhelp@uwo.ca)**

Submit by E-mail

Print Form

Date of Interruption/Closure Nov 1, 2014

Time(s): 7:00 am - 5:00pm

Building(s) #1 DENTAL SCIENCE BUILDING (DSB)  
Affected: #3

#2

#4

Areas/Rooms Affected Alternate Route/Service:

EXIT 1 Closure, Alternate Route - HSA Exit 4.  
See attached map.

Service to be #1 Traffic Area  
interrupted: #3

#2

#4

Description/Reason for Project:

Close off entrance for demolition of tiles above doors inside lobby for future H/C operator.

Requester: Ted Chelchowski

Date of Request: Oct 24, 2014

Supervising Tradesperson:

Unit:

Trade Supervisor:

Unit:

Date:

Contractor: Trela Enterprises

Phone # +1 (226) 688-8671

Coordinator/Project Manager: Ted Chelchowski

Phone # 88954

Date: Oct 24, 2014

Reviewed by Trade Supervisor(s)/Shop(s) Affected:

Name: Ted Chelchowski

Date: Oct 24, 2014

Signature/  
Stamp:

Signature/  
Stamp:

REVIEWED

By Frank (ffaroni@uwo.ca) at 10:09 am, Oct 28, 2014

Name:

Date:

Signature/  
Stamp:

Name:

Date:

Signature/  
Stamp:

Name:

Date:

Signature/  
Stamp:

Principal Occupants:

Name:

Ext.

Date:

Name:

Ext.

Date:

Name:

Ext.

Date:

Name:

Ext.

Date:

Approval to Proceed:

Date:

**APPROVED**

By Dan Trudgeon (fminterr@uwo.ca) at 10:39 am, Oct 28, 2014

Notes: Note: Exit will be accessible under any emergencies - ex. Fire Alarms  
Also detour signs will be posted in HSA. - Ted

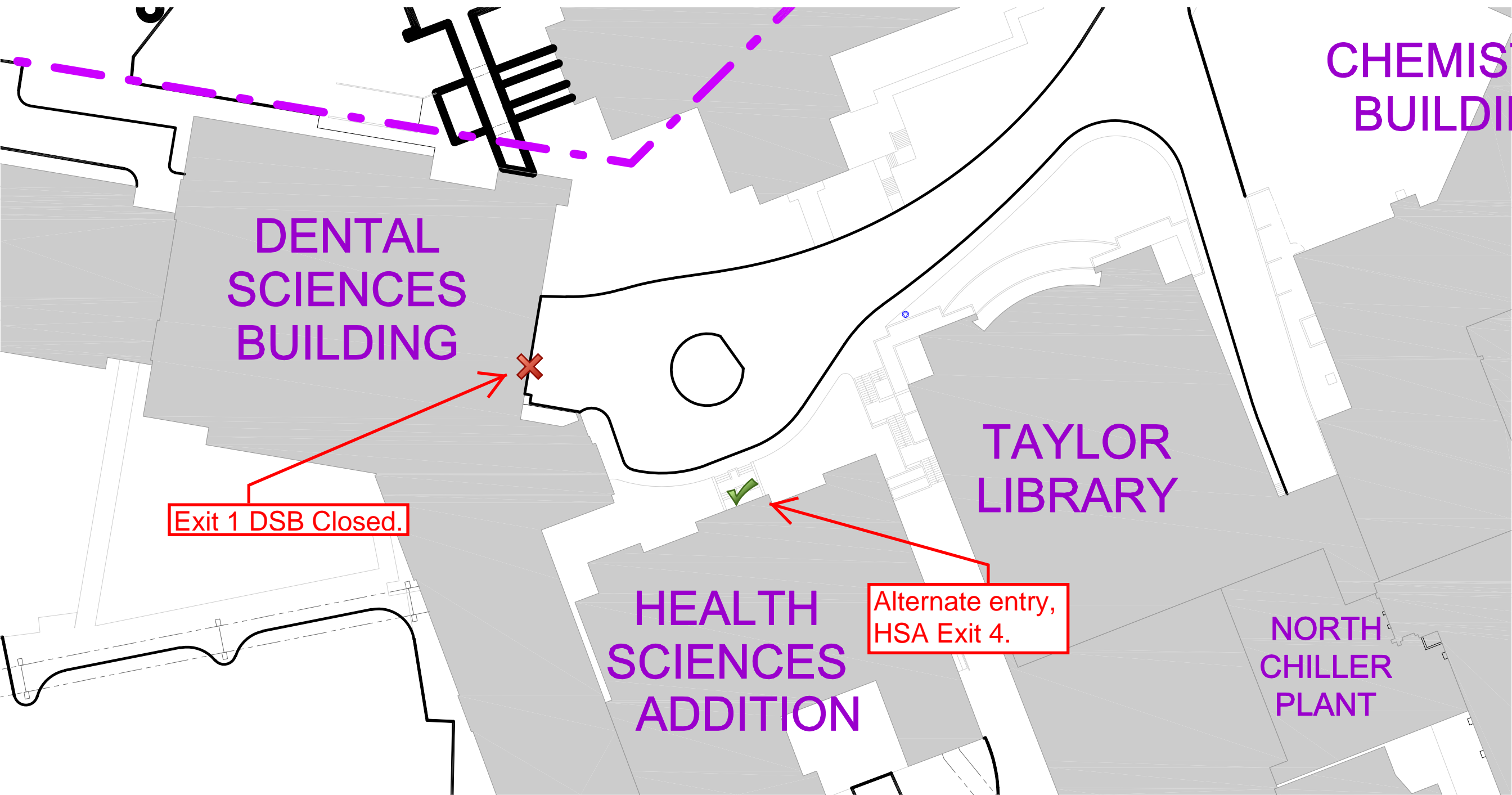



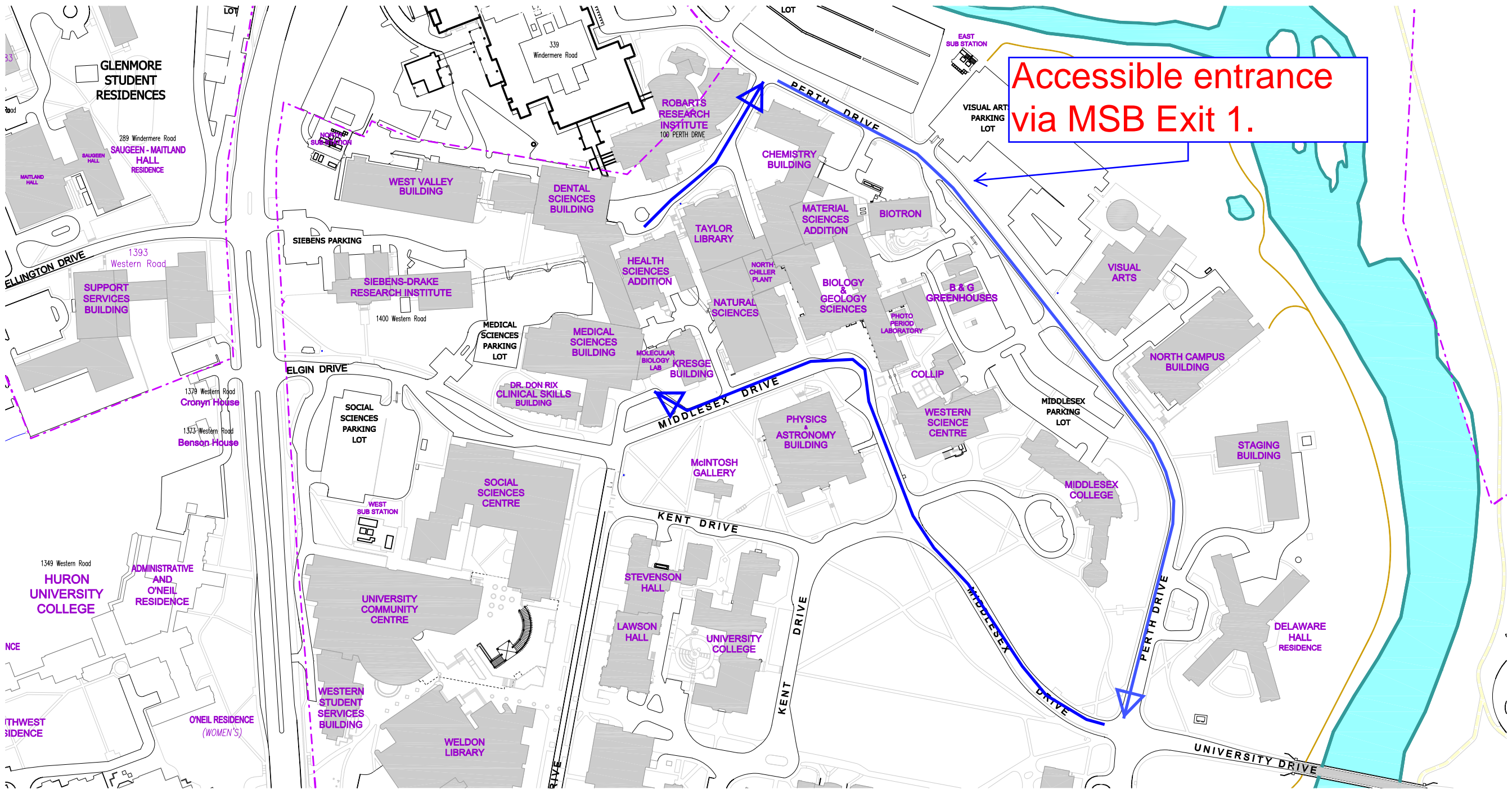

Accessible entrance  
via MSB Exit 1.