



**Notice of Service Interruption/Area Closure**  
**Western University**  
**Facilities Management**  
**Client Services 519-661-3304 (fmhelp@uwo.ca)**

Submit by E-mail  
 Print Form

Date of Interruption/Closure:  Time(s):

Building(s) Affected: #1  #2   
 #3  #4   
 Areas/Rooms Affected Alternate Route/Service:

Service to be interrupted: #1  #2   
 #3  #4   
 Description/Reason for Project:

Requester:  Date of Request:

Supervising Tradesperson:  Unit:   
 Trade Manager:  Unit:  Date:

Contractor:  Phone #:   
 Coordinator/Project Manager:  Phone #:  Date:

Reviewed by Trade Manager(s)/Shop(s) Affected:

Name:	Date:	Name:	WES Control	Date:	May 23, 2018
Signature/Stamp:		Signature/Stamp:	<b>REVIEWED</b> <i>By Jesse Atkinson (jatkin48@uwo.ca) at 9:53 am, May 23, 2018</i>		

Principal Occupants:

Name:	Ext.:	Date:
Name:	Ext.:	Date:
Name:	Ext.:	Date:
Name:	Ext.:	Date:

Approval to Proceed:  Date:

**APPROVED**  
*By Dara Gomez at 9:57 am, May 23, 2018*

Notes:

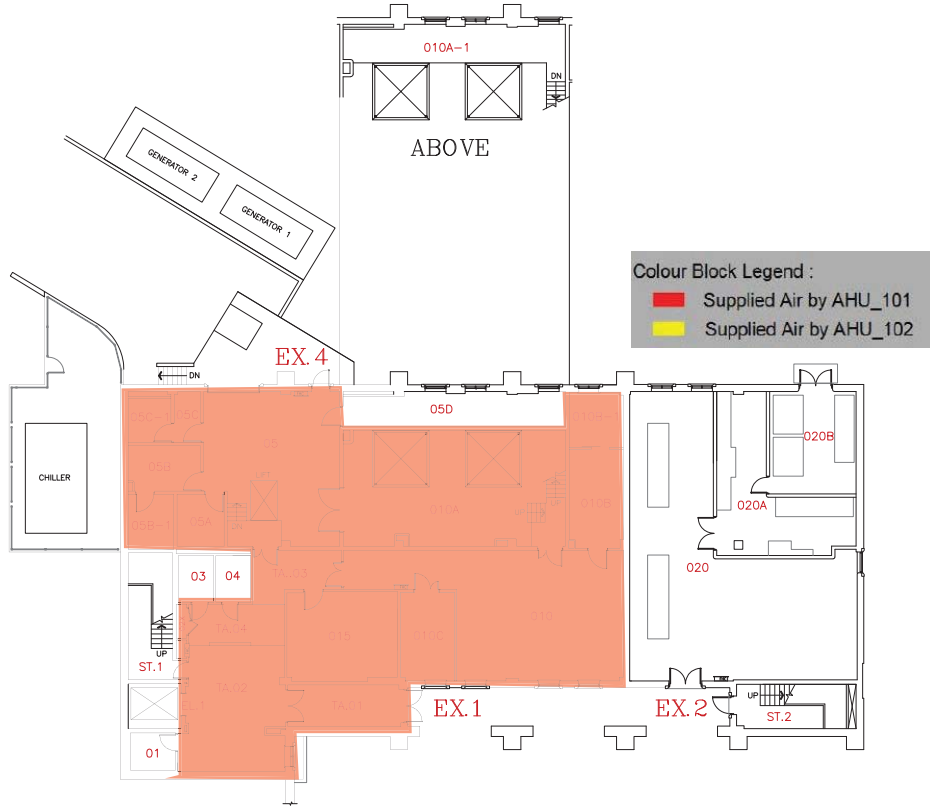

	SCALE
	DATE 2014-06-05
	DRAWN R. THOMAS
	CHECKED
<b>FACILITIES MANAGEMENT</b>	
DWG. FILE No. BERF-01 GEODETTIC ELEV.	
BUILDING FLOOR PLAN - LEVEL 01 (LOWER GROUND FLOOR PLAN)	
<b>BIOTRON FACILITY</b>	
<span style="font-size: 2em;">01</span>	

Colour Block Legend :

- Supplied Air by AHU\_101
- Supplied Air by AHU\_102



	BUILDING NORTH
<b>FACILITIES MANAGEMENT</b>	SCALE
DATE 2015-03-12	DRAWN R. THOMAS
CHECKED	APPROVED
DWG. FILE No. BERF-02	GEODETTIC ELEV.
BUILDING FLOOR PLAN - LEVEL 02 (GROUND FLOOR PLAN)	02
BIOTRON FACILITY	

Colour Block Legend :

- Supplied Air by AHU\_101
- Supplied Air by AHU\_102



SCALE
DATE
2015-01-30
DRAWN
R. THOMAS
CHECKED
APPROVED

**FACILITIES MANAGEMENT**

DWG. FILE No.  
BERF-03

SCALE 50

GEODETIC ELEV.

BUILDING FLOOR PLAN - LEVEL 03  
(LEVEL 1 FLOOR PLAN)

**BIOTRON FACILITY**

03

Colour Block Legend :

Red	Supplied Air by AHU 101
Green	Supplied Air by AHU 103
Yellow	Supplied Air by AHU 104
Blue	Supplied Air by AHU 105
Grey	Supplied Air by AHU 106
Teal	Supplied Air by AHU 107
Black	Supplied Air by AHU 108



		<p>BUILDING NORTH</p>		<p>SCALE</p> <p>DATE 2013-11-11</p> <p>DRAWN R. THOMAS</p> <p>CHECKED</p> <p>APPROVED</p>
<p><b>FACILITIES MANAGEMENT</b></p>		<p>DWG. FILE No. BERF-05</p> <p>GEODETIC ELEV.</p>		<p>05</p>
<p>SCALE</p>		<p>BUILDING FLOOR PLAN – LEVEL 05 (LEVEL 3 FLOOR PLAN)</p> <p><b>BIOTRON FACILITY</b></p>		

BIOTRON FUME HOOD CONTACT INFO			
ROOM #	FUME CAB / FAN #	CONTACT NAME	EXTENSION #
015	1 CABINET	C. WU	X83791
010	1 CABINET	M. DURR	X89045
5	1 CABINET	BRIAN BRANFIREUN	X89221
5E?	1 CABINET	DANIELLE WAY	X88734
20B	1 CABINET	ZOE LINDA	???
105	1 CABINET	DR. R.B. GARDINER	X82241
120	1 CABINET	STEVE BARTLETT	X89039

NOTE: TONY HAMMOUD PASSED ON CONTACT INFO FOR ANNE MARIE MC CUSKER EX#84741.  
CONTACT HER FOR SPECIFIC CHEMICALS USED!